



Wisconsin Department of Transportation

February 5, 2026

**Division of Transportation Systems
Development**

Bureau of Project Development
4822 Madison Yards Way, 4th Floor South
Madison, WI 53705

Telephone: (608) 266-1631

Facsimile (FAX): (608) 266-8459

NOTICE TO ALL CONTRACTORS:

**Proposal #41: 8460-00-70, WISC 2026195
STH 40 – STH 27
Chippewa River Bridge, B-57-0018
CTH D
Sawyer County**

Letting of February 10, 2026

This is Addendum No. 01, which provides for the following:

Plan Sheets:

Revised Plan Sheets	
Plan Sheet	Plan Sheet Title (brief description of changes to sheet)
14	Structure Plan Sheet 1 – General Plan (revised streambed and water elevations)

The responsibility for notifying potential subcontractors and suppliers of these changes remains with the prime contractor.

Sincerely,

Mike Coleman

Proposal Development Specialist
Proposal Management Section

END OF ADDENDUM

STATE PROJECT NUMBER

8460-00-70

Addendum No. 01
ID 8460-00-70
Revised Sheet 14
February 5, 2026

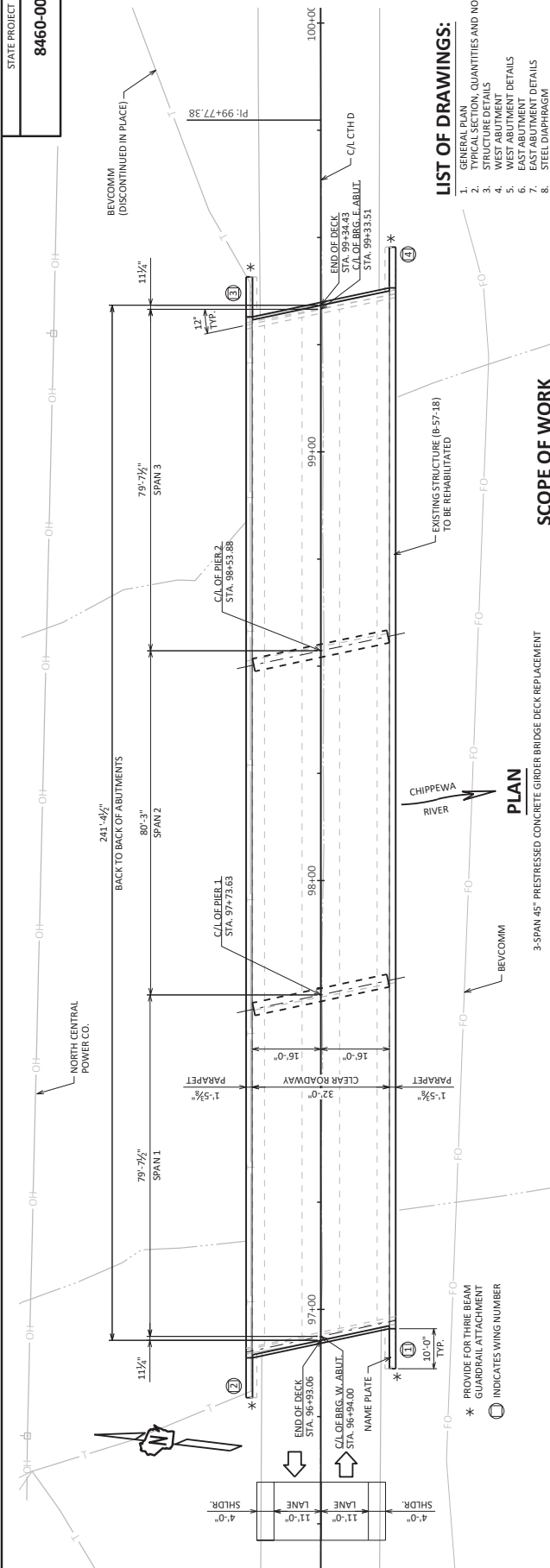

LIST OF DRAWINGS:

1. GENERAL PLAN
2. TYPICAL SECTION, QUANTITIES AND NOTES
3. STRUCTURE DETAILS
4. WEST ABUTMENT DETAILS
5. WEST PIER DETAILS
6. EAST ABUTMENT DETAILS
7. EAST PIER DETAILS
8. STEEL DIAPHRAGM
9. DECK ELEVATIONS AND DEAD LOAD DEFLECTIONS
10. SUPERSTRUCTURE LONG SECTION AND DETAILS
11. SUPERSTRUCTURE DETAILS
12. SUPERSTRUCTURE PLAN
13. SUPERSTRUCTURE TRANSVERSE DECK STEEL LAYOUT
14. SINGLE SLOPE PARAPET 4255

SCOPE OF WORK

1. REPLACE CONCRETE DECK
2. REPLACE TOP OF WINGS
3. REPLACE TOPS OF WINGS
4. CONCRETE SURFACE REPAIR ON ABUTMENT WALLS
5. FILL VOID UNDER ABUTMENTS

PLAN

3-SPAN 45' PRESTRESSED CONCRETE GIRDER BRIDGE DECK REPLACEMENT

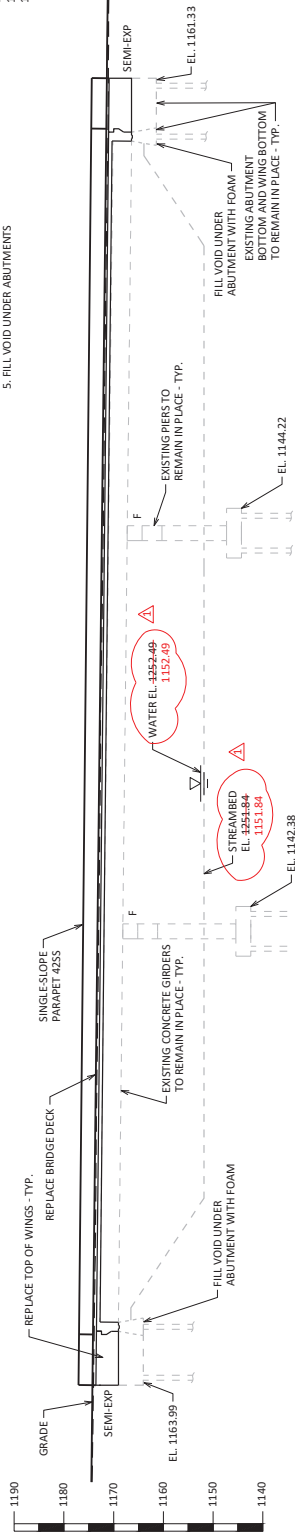

ELEVATION

NORMAL TO THE C/L OF CHIPPEWA RIVER

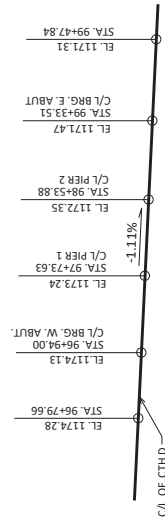

PROFILE GRADE LINE
(C/L D)

NO.	STATION	ELEV.	DESCRIPTION
50	102+63.4	1170.138	RR SPIKE IN PROJ. 54' LT.
51	96+85.5	1173.571	WISDOT MON. IN BRIDGE ABUT., 165' LT.



02/04/2026

STRUCTURE DESIGN CONTACTS:
ARLEN BEAUDETTE 715-834-3161
AARON BOMK 608-264-0061

02/03/2026

NO.	DATE	REVISION	BY
1	02/03/26	STREAM ELEVATIONS	AEB

ORIGINAL PLANS PREPARED BY
AYRES
3433 Oakwood Hills Parkway
Eau Claire, WI 54601
www.AyresAssociates.com

8

8

STATE OF WISCONSIN
DEPARTMENT OF TRANSPORTATION
ACCEPTED: CHIEF STRUCTURES DESIGN ENGINEER DATE

STRUCTURE B-57-18
COUNTY SAWYER TOWN

DESIGNER: CTH D OVER CHIPPEWA RIVER
REHABILITATION N/A
BY: NBE CTD ZSS BY: DRG/CLP CTD AEB

GENERAL PLAN
SHEET 1 OF 15

DATE: 14