



Wisconsin Department of Transportation

January 30, 2026

Division of Transportation Systems Development

Bureau of Project Development
4822 Madison Yards Way, 4th Floor South
Madison, WI 53705

Telephone: (608) 266-1631
Facsimile (FAX): (608) 266-8459

NOTICE TO ALL CONTRACTORS:

Proposal #34: 9835-06-70, WISC 2026203
C Antigo, 10th Avenue
Western Avenue to Clermont Street
Loc Str
Oneida County

Letting of February 10, 2026

This is Addendum No. 01, which provides for the following:

Special Provisions:

Added Special Provisions	
Article No.	Description
64	Excavation, Hauling, and Disposal of Contaminated Soil and Management of Groundwater, SPV.0195.02

Deleted Special Provisions	
Article No.	Description
61	Hauling and Disposal of Contaminated Soil and Management of Groundwater, SPV.0195.01

Schedule of Items:

Added Bid Item Quantities					
Bid Item	Item Description	Unit	Proposal Total Prior to Addendum	Quantity Added	Proposal Total After Addendum
SPV.0195.02	Excavation, Hauling, and Disposal of Contaminated Soil and Management of Groundwater	TON	0	685	685

Deleted Bid Item Quantities					
Bid Item	Item Description	Unit	Proposal Total Prior to Addendum	Proposal Quantity Change (-)	Proposal Total After Addendum
SPV.0195.01	Hauling and Disposal of Contaminated Soil and Management of Groundwater	TON	685	685	0

Plan Sheets:

Revised Plan Sheets	
Plan Sheet	Plan Sheet Title (brief description of changes to sheet)
10	Typical Section (Update to S. Mayfair Street finished typical section).
132	Miscellaneous Quantities (Revision in Hauling and Disposal of Contaminated Soil and Management of Groundwater naming and item numbering)

Added Plan Sheets	
Plan Sheet	Plan Sheet Title (brief description of why sheet was added)
5A	Typical Section (addition of side street existing typical section)
10A	Typical Section (addition of side street finished typical section)
163A	Plan and Profile (addition of side street profiles)
257A-D	Side Street Cross Sections (Deleglise Street, Weix Street, Wausau Road, and Gowan Road)

The responsibility for notifying potential subcontractors and suppliers of these changes remains with the prime contractor.

Sincerely,

Mike Coleman

Proposal Development Specialist
Proposal Management Section

ADDENDUM NO. 01

9835-06-70

January 30, 2026

Special Provisions

61. DELETED

64. Excavation, Hauling and Disposal of Contaminated Soil and Management of Groundwater, Item SPV.0195.02.

A Description

A.1 General

This special provision describes excavating, loading, hauling, and disposing of petroleum-, metals-, and VOC (volatile organic compound)- contaminated soil and sediment at a DNR approved bioremediation facility or landfill. The closest DNR approved bioremediation facilities or landfills are:

Marathon County Solid Waste
172900 Wi-29
Ringle, WI
(715) 944-8198

Lincoln County Sanitary Landfill
N4750 Landfill Ln
Merrill, WI 54452-8522
(715) 536-9636

Perform this work conforming to standard spec 205 and Chapters NR 700-754 of the Wisconsin Administrative Code, as supplemented herein. Per NR 718.07, a solid waste collection and transportation service-operating license is required under NR 502.06 for each vehicle used to transport contaminated soil and sediment.

Work also consists of dewatering excavations, temporarily storing contaminated water in tank(s) or tanker truck(s), and disposal of contaminated groundwater to the sanitary sewer from the contaminated areas.

A.2 Notice to the Contractor – Contaminated Soil, Sediment, and Groundwater Locations

The department completed testing for soil contamination for locations within this project where excavation is required. Testing indicated that metals-, VOC-, and PAH-contaminated soil, sediment, and/or groundwater, as well as industrial fill material, are present at the following locations:

Contaminated Soil and/or Groundwater

1. Station 65+00 to 67+50, from construction limits right of reference line to construction limits left of reference line, from existing grade to 10+ feet below grade.
2. Station 68+80 to 71+25, from construction limits right of reference line to construction limits left of reference line, from existing grade to 5+ feet below grade.
3. Ramboll Americas Engineering Solutions, Inc. and their contractors have completed remediation of the Former Manufactured Gas Plant site by In-Situ Solidification (ISS) between station 69+60 and station 71+25. Additional remediation was also completed east of the project limits.
4. Station 278+12.5 to 280+50 from construction limits right of reference line to construction limits left of reference line, from existing grade to 10+ feet below grade.

Metals-Contaminated Soil

1. Station 64+25 to Station 64+45, from the reference line to construction limits right of the reference line, from existing grade to 5+ feet below grade.

Contaminated Sediment

1. Station 278+12.5 to 278+33 from construction limits left to construction limits right. Depth of contamination ranges from the sediment surface to 2 feet below the sediment surface.

If contaminated soils, sediment, groundwater, and/or underground storage tanks (USTs) are encountered elsewhere on the project, terminate excavation activities in the area and notify the engineer. If petroleum film (sheen) or odors are observed during dewatering activities at other locations on the project, terminate dewatering activities and notify the engineer. Contaminated soil and groundwater at other locations shall be managed by the contractor under this contract, under direction of the engineer and the environmental consultant. USTs will be removed by others.

For further information regarding previous investigation and remediation activities at these sites contact:

Name: Bree Richardson
Address: 510 Hanson Lake Rd, Rhinelander, WI 54501
Phone: (715) 315-8058
E-mail: bree.richardson@dot.wi.gov

Consultant: TRC Environmental Corporation
Contact: Dan Haak
Address: 999 Fourier Drive, Suite 101, Madison, WI 53717
Phone: (608) 826-3628
Fax: (608) 826-3941
E-mail: dhaak@trccompanies.com

A.3 Coordination

Coordinate work under this contract with the environmental consultant:

Consultant: TRC Environmental Corporation
Contact: Dan Haak, P.E.
Address: 999 Fourier Drive, Suite 101, Madison, WI 53717
Phone: (608) 826-3628
Fax: (608) 826-3941
E-mail: dhaak@trccompanies.com

The role of the environmental consultant will be limited to:

1. Determining the location and limits of contaminated soil and sediment to be excavated based on soil and sediment analytical results from previous investigations, visual observations, and field screening of soil and sediment that is excavated;
2. Identifying contaminated soils and sediment to be hauled to the bioremediation facility or landfill;
3. Documenting that activities associated with management of contaminated soil and sediment are in conformance with the contaminated soil and sediment management methods for this project as specified herein;
4. Obtaining the necessary approvals for disposal of contaminated soil and sediment from the bioremediation facility or landfill; and
5. Identifying contaminated groundwater to be pumped for treatment and disposal (if dewatering is necessary).

Provide at least a 14-calendar day notice of the preconstruction conference date to the environmental consultant. At the preconstruction conference, provide a schedule for all excavation activities in the areas of contamination to the environmental consultant. Also notify the environmental consultant at least three calendar days before beginning excavation activities in the contaminated area.

Coordinate with the environmental consultant to ensure that the environmental consultant is present during excavation activities in the contaminated area. Perform excavation work in the contaminated area on a continuous basis until excavation work is completed.

Identify the DNR approved bioremediation facility or landfill that will be used for disposal of contaminated soils and sediment and provide this information to the environmental consultant no later than 30 calendar days before beginning excavation activities in the contaminated areas or at the preconstruction conference, whichever comes first. The environmental consultant will be responsible for obtaining the necessary approvals for disposal of contaminated soils and sediment from the bioremediation facility or landfill. Do not transport contaminated soil or sediment offsite without prior approval from the environmental consultant. Do not pump or haul contaminated groundwater offsite without specific approval from the environmental consultant.

A.4 Health and Safety Requirements

Add the following to standard spec 107.1:

During excavation activities, expect to encounter soil and sediment contaminated with metals, gasoline, diesel fuel, fuel oil, or other petroleum related products. Site workers taking part in activities that will result in the reasonable probability of exposure to safety and health hazards associated with hazardous materials shall have completed health and safety training that meets the Occupational Safety and Health Administration (OSHA) requirements for Hazardous Waste Operations and Emergency Response (HAZWOPER), as provided in 29 CFR 1910.120.

Prepare a site-specific Health and Safety Plan, and develop, delineate and enforce the health and safety exclusion zones for each contaminated site location as required by 29 CFR 1910.120. Submit the site-specific health and safety plan and written documentation of up-to-date OSHA training to the engineer before the start of work.

Disposal of contaminated soil and sediment at the bioremediation and/or disposal facility is subject to the facility's safety policies.

B (Vacant)

C Construction

Add the following to standard spec 205.3:

Control operations in the contaminated area to minimize the quantity of contaminated soil and sediment excavated.

The environmental consultant will periodically evaluate soil and sediment excavated from the contaminated area to determine if the soil and sediment will require offsite disposal. The environmental consultant will evaluate excavated soil and sediment based on field screening results, visual observations, and soil and sediment analytical results from previous environmental investigations. Assist the environmental consultant in collecting soil and sediment samples for evaluation using excavation equipment. The sampling frequency shall be a maximum of one sample for every 20 cubic yards excavated.

On the basis of the results of such field-screening, the material will be designated for disposal as follows:

- Excavation Common consisting of clean soil and/or clean construction and demolition fill (such as clean soil, boulders, concrete, reinforced concrete, bituminous pavement, bricks, building stone, and unpainted or untreated wood), which under NR 500.08 are exempt materials, or
- Low-level contaminated material (PID readings less than 10 ppm and no observation of staining or petroleum odor, or based on existing analytical data) for reuse as fill within the construction limits as allowed, or
- Petroleum-contaminated soil (significant petroleum odor, staining, and/or PID readings greater than 10 ppm) for off-site treatment and disposal at the WDNR-licensed bioremediation facility, or
- Contaminated soil (based on the presence of industrial fill or existing analytical data) for off-site disposal at the WDNR-licensed disposal facility, or
- Potentially contaminated for temporary stockpiling and additional characterization prior to disposal.

Directly load and haul soils and sediment designated by the environmental consultant for offsite bioremediation or landfilling to the DNR approved bioremediation facility or landfill. Verify that vehicles used to transport contaminated material are licensed for such activity in accordance with applicable state and federal regulations. Use loading and hauling practices that are appropriate to prevent any spills or releases

of petroleum-contaminated soils and sediment or residues. Before transport, sufficiently dewater soils and sediment designated for off-site bioremediation or landfilling so as not to contain free liquids.

Sediment dewatering will be conducted in accordance with best management practices and will comply with the requirements of all applicable state and federal permits. Filtered water from dewatered sediments can be discharged back into the body of water from which it was removed.

Some material may require additional characterization prior to disposal. Provide for the temporary stockpiling of up to 100 cubic yards of contaminated soil on-site that requires additional characterization. Construct and maintain a temporary stockpile of the material according to NR 718.05(3), including, but not limited to, placement of the contaminated soil/fill material on an impervious surface and covering the stockpile with impervious material to prevent infiltration of precipitation. The department's environmental consultant will collect representative samples of the stockpiled material, laboratory-analyze the samples, and advise the contractor, within 10 business days of the construction of the stockpile, of disposal requirements. The stockpiled material shall be disposed either at the WDNR-licensed disposal facility by the contractor or, if characterized as hazardous waste, by the department. As an alternative to temporarily stockpiling contaminated soil/fill material that requires additional characterization, the contractor has the option of suspending excavation in those areas where such soil is encountered until such time as characterization is completed.

Obtain approval from the engineer for the stockpile location. Construct the stockpile in an orderly fashion and compact to minimize the surface area of the cover.

If dewatering is required in areas of known contamination, water generated from dewatering activities may contain petroleum compounds, chlorinated volatile organic compounds, and/or metals. Such water may require analytical testing, special handling, temporary storage, and disposal. If dewatering is necessary, the water shall be pumped into a holding tank or tanker truck for off-site testing and disposal. Disposal of contaminated water may require use of a licensed hazardous waste hauler to transport contaminated groundwater to a treatment and disposal facility.

Contaminated groundwater may be discharged to the City of Antigo sanitary sewer at an approved location identified by the City.

Ensure continuous dewatering and excavation safety at all times. Contractor shall perform all necessary monitoring to document compliance with the requirements of the City of Antigo Wastewater Treatment Facility. Furnish install, operate, maintain, disassemble, and remove treatment equipment necessary to comply with the requirements of the Antigo Wastewater Treatment Facility.

Contacts:

City of Antigo Department of Public Works
700 Edison Street
Antigo, WI 54409
Attn: Charley Brinkmeier (715) 623-3633 ext. 132; cbrinkmeier@antigo-city.org

Facility Requirements:

1. Contaminated groundwater may only be discharged at the southeast corner of the intersection of Deleglise Street and STH 64 (Century Avenue) in the City of Antigo, as determined by the City.
2. The City shall be notified when a discharge is anticipated, started, and completed. (Email Charley Brinkmeier)
3. The Contractor shall use an approved method to prevent sand, grit, and gravel from entering the sanitary system.
4. The Contractor shall meter or otherwise estimate the amount of discharge into the system.
5. The Contractor shall monitor a manhole upstream and downstream to verify the discharge is not surcharging the sewer.

Complete dewatering activities in the contaminated areas to remove contaminated water, as determined by the environmental consultant, from the excavation as necessary to complete construction. Allow contaminated water encountered, but not requiring removal as a standard course of construction, to remain in-place and do not manage in accordance to this special provision.

As an alternative, temporary holding tanks may be used to pump contaminated water, as determined by environmental consultant, for treatment and disposal at an approved facility, as necessary to complete construction.

Discharging contaminated groundwater to any location other than that approved and provided by the City of Antigo is at the contractor's cost. If the contractor chooses alternate discharge, at the contractor's cost, obtain DNR concurrence on any dewatering plans, and provide and operate any and all treatment and discharge equipment required.

Costs associated with excavation dewatering in contaminated areas are considered incidental to this pay item. The City of Antigo will be the generator of regulated solid waste from this construction project.

Contractor shall ensure continuous dewatering and excavation safety at all times. Provide, install, operate, maintain adequate pumping equipment, disassemble, and remove pumping equipment

Provide, operate, and maintain adequate pumping and water storage equipment. Minimize the amount and duration of pumping to minimize the amount of water necessary to discharge into the sanitary sewer. Limit excavation at the location described in A.2 to minimize the handling of groundwater. Take measures to limit groundwater, surface water, and precipitation from entering and exiting excavations in the areas of contamination. Such measures, which may include berming, ditching, or other means, shall be maintained until construction of utilities in the areas of contamination are complete. Notify the engineer of any dewatering activities and obtain any permits necessary to dispose of contaminated groundwater, and coordinate with the City of Antigo as necessary to discharge water, including permits if required. Provide copies of such Permit to the engineer. Meet any requirements and pay any costs for obtaining and complying with such permit use. Follow all applicable legislative statutes, judiciary decisions, and regulations of the State of Wisconsin.

D Measurement

The department will measure Excavation, Hauling, and Disposal of Contaminated Soil and Management of Groundwater in tons of contaminated soil and sediment, accepted by the bioremediation facility or landfill as documented by weight tickets generated by the bioremediation facility or landfill.

E Payment

The department will pay for measured quantities at the contract unit price under the following bid item:

ITEM NUMBER	DESCRIPTION	UNIT
SPV.0195.02	Excavation, Hauling, and Disposal of Contaminated Soil and Management of Groundwater	TON

Payment is full compensation for excavating, segregating, loading, hauling, and treatment via bioremediation, or landfilling of contaminated soil and sediment; obtaining solid waste collection and transportation service operating licenses; assisting in the collection soil and sediment samples for field evaluation; dewatering of soils and sediment before transport, if necessary; and management of contaminated groundwater.

Schedule of Items

Attached, dated January 30, 2026, are the revised Schedule of Items Page 12.

Plan Sheets

The following 8½ x 11-inch sheets are attached and made part of the plans for this proposal:

Revised: 10, 132

Added: 5A, 10A, 163A, and 257A-D.

END OF ADDENDUM

Addendum No. 01
ID 9835-06-70
Added Sheet 5A
January 30, 2026

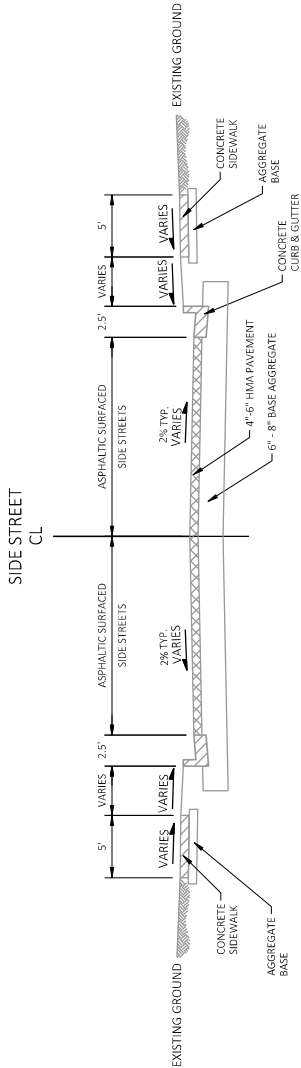

EXISTING TYPICAL SECTION FOR SIDE STREETS

Side Street Name	Station - Station	Concrete Sidewalk Width Left	Terrace Width Left	Roadway Width Left	Roadway Width Right	Terrace Width Right	Concrete Sidewalk Width Right
Deleglise Street	210+18-210+68	5.0'	9.8'	16.0'	15.5'	N/A	N/A
Weix Street	220+18-220+55	N/A	N/A	12.0'	14.0'	N/A	N/A
Wausau Road	229+33-229+80	N/A	N/A	12.8' - 17.9'	11.3' - 15.1'	N/A	N/A
Gowan Road	239+35-239+82	N/A	N/A	16.9'	17.0'	5.8'	5.0'

10TH AVENUE

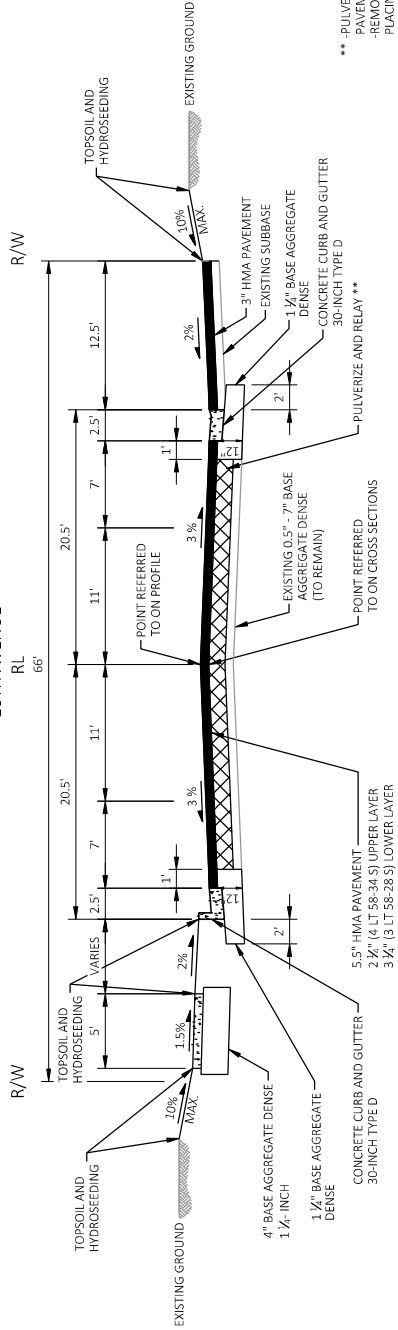

** - PULVERIZE & RELAY 10" DEEP FROM EXISTING PAVEMENT SURFACE.
- REMOVE EXCESS PULVERIZED MATERIAL BEFORE PLACING 4" HMA PAVEMENT.

* SHARED PARKING & BICYCLE FACILITY

FINISHED TYPICAL SECTION
STA 61+27 - STA 71+25

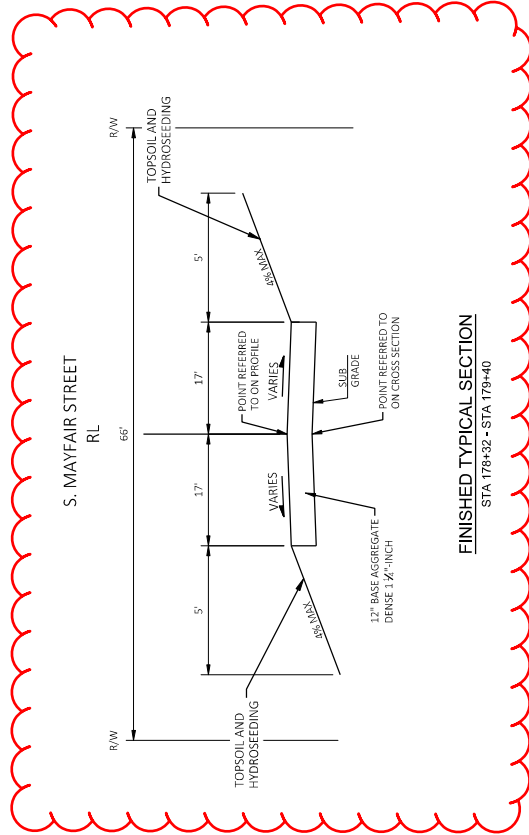

Addendum No. 01
ID 9835-06-70
Revised Sheet 10
January 30, 2026

Addendum No. 01
ID 9835-06-70
Added Sheet 10A
January 30, 2026

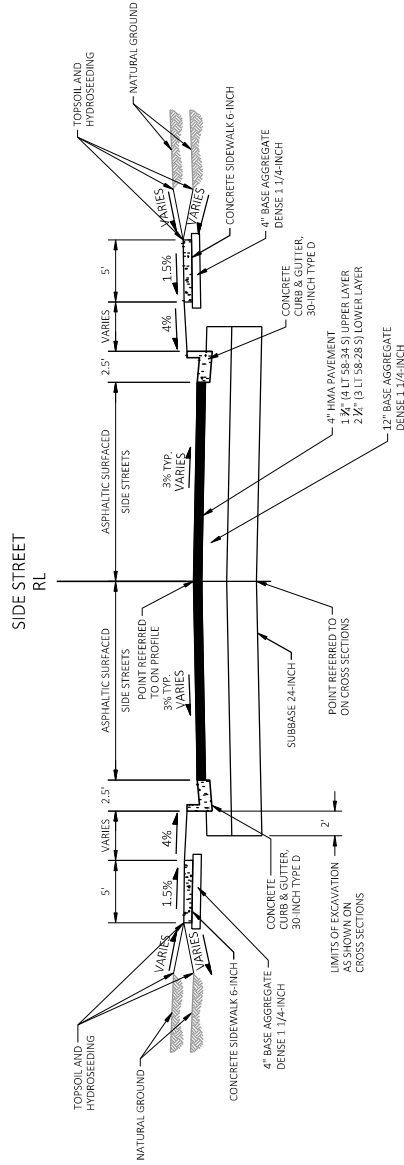

FINISHED TYPICAL SECTION FOR SIDE STREETS

SIDE STREET NAME	STATION - STATION	CONCRETE SIDEWALK WIDTH LEFT	TERRACE WIDTH LEFT	ROADWAY WIDTH LEFT	ROADWAY WIDTH RIGHT	TERRACE WIDTH RIGHT	CONCRETE SIDEWALK WIDTH RIGHT
DELEGUISE STREET	210+18-210+68	5.0'	7.5'	15.5'	15.5'	5.0'	N/A
WEIX STREET	220+18-220+55	N/A	5.0'	13.0'	13.0'	5.0'	N/A
WAUSAU ROAD	229+35-229+80	N/A	N/A	16.5'	14.5' - 28.2'	N/A	N/A
GOWAN ROAD	239+35-239+82	N/A	N/A	13.0' - 25.3'	16.9'	5.3' - 5.8'	5.0'

STORM SEWER REMOVALS

CATEGORY	STATION	TO	STATION	LOCATION	204.0210		204.0220		204.0245.01		204.0245.02		204.0245.03		204.0245.04		204.0245.05		204.0245.06	
					REMOVING MANHOLES EACH		REMOVING INLETS EACH		REMOVING STORM SEWER 8-INCH LF		REMOVING STORM SEWER 10-INCH LF		REMOVING STORM SEWER 12-INCH LF		REMOVING STORM SEWER 15-INCH LF		REMOVING STORM SEWER 24-INCH LF		REMOVING STORM SEWER 42-INCH LF	
0010	10+10	-	27+75	10TH AVENUE	-		6		-		-		-		188		-		-	
0010	33+25	-	41+75	10TH AVENUE	-		7		85		79		-		47		-		-	
0010	41+75	-	48+75	10TH AVENUE	-		2		39		-		-		-		-		-	
0010	48+75	-	53+25	10TH AVENUE	2		9		250		-		78		-		132		325	
0010	56+25	-	61+25	10TH AVENUE	2		8		278		-		30		-		-		-	
0010	62+00	-	67+25	10TH AVENUE	-		4		87		54		-		-		-		-	
0010	67+25	-	71+25	10TH AVENUE	-		2		-		40		10		-		-		-	
0010	160+40	-	161+53	SUNSET DRIVE	-		4		-		72		45		59		-		-	
0010	278+31	-	280+36	EDISON STREET	1		-		-		-		10		-		205		-	
TOTAL 0010					5		42		739		245		173		294		337		325	

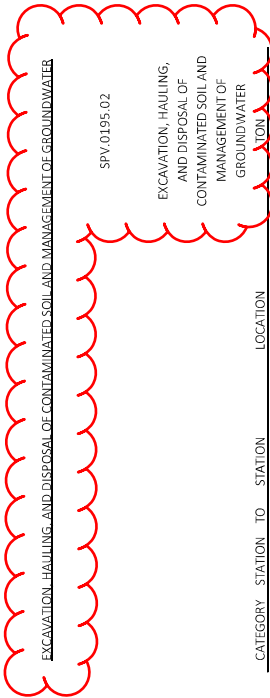

Addendum No. 01
ID 9835-06-70
Revised Sheet 132
January 30, 2026

CATEGORY	STATION	TO	STATION	LOCATION	LF
0020	65+00	-	71+25	10TH AVENUE	480
0020	278+12	-	280+50	EDISON STREET	205
TOTAL 0020					685

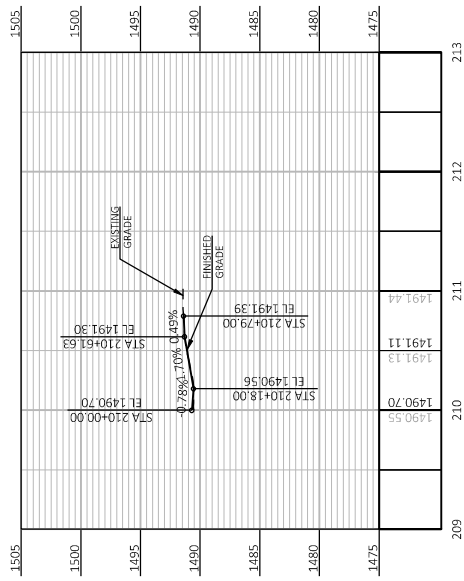

DELEGUSE STREET

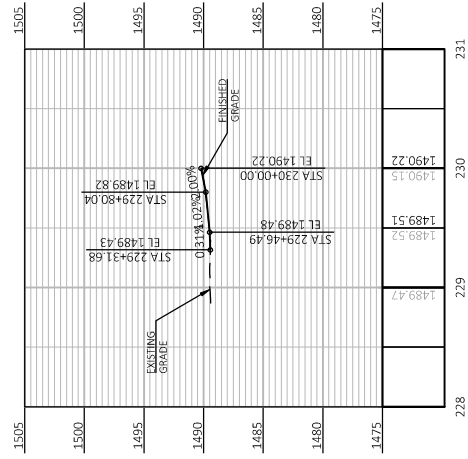

WAUSAU ROAD

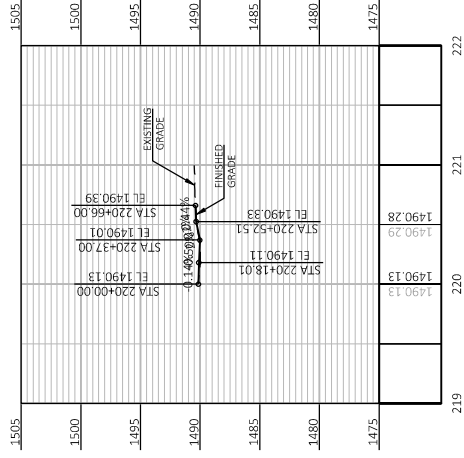

WIEX STREET

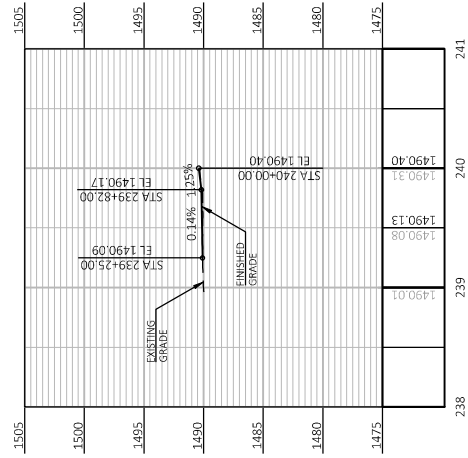

GOWMAN ROAD

Addendum No. 01
ID 9835-06-70
Added Sheet 163A
January 30, 2026

Addendum No. 01
ID 9835-06-70
Added Sheet 257A
January 30, 2026

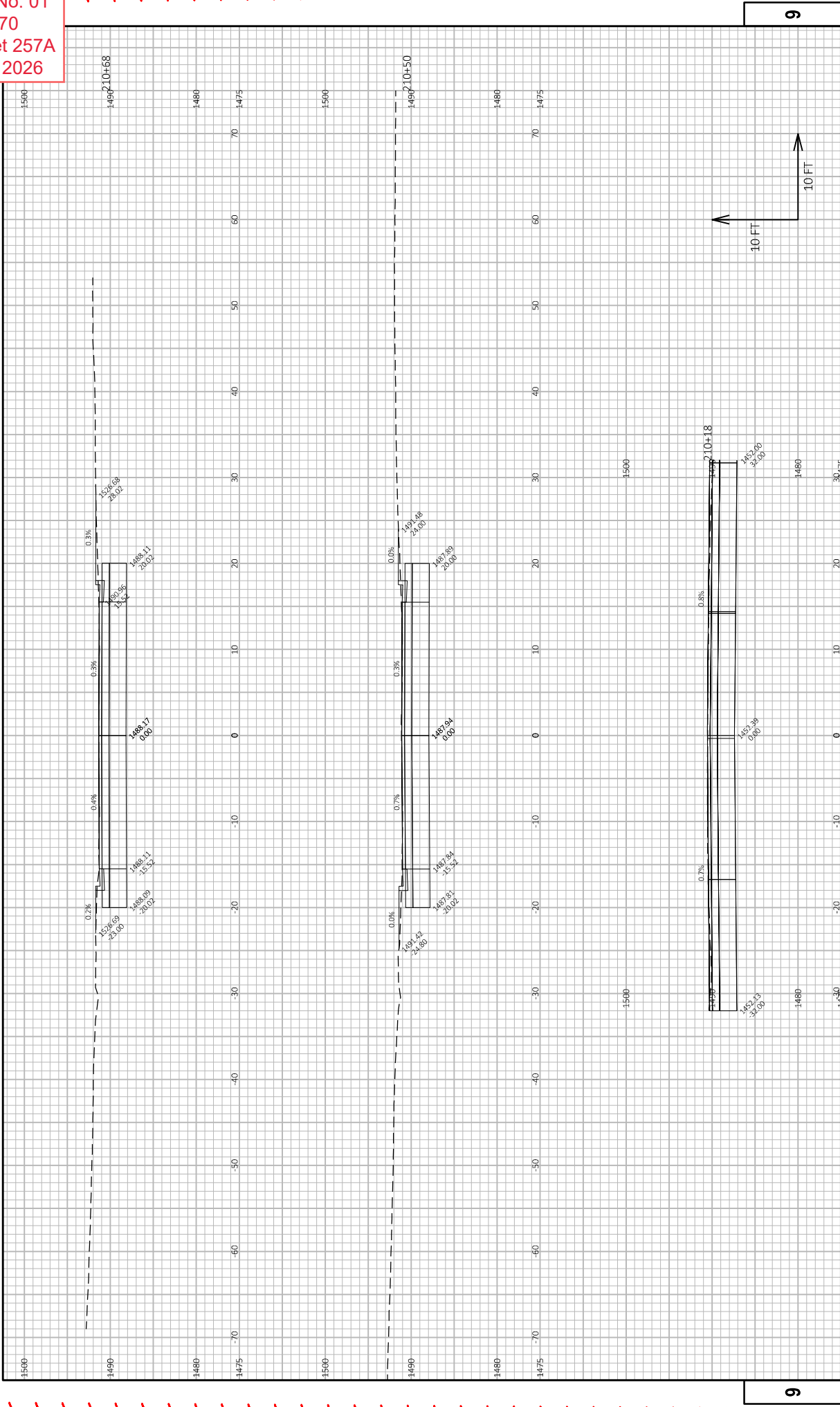

PROJECT NO: 9835-06-70	HWY: 10TH AVENUE	COUNTY: LANGLADE	CROSS SECTIONS: DELEGISE STREET	SHEET 257A
FILE NAME: I:\35\ANTIGO CITY OF 05-0832.00_ANTI GO 10TH AVE WESTERN AVE - EAST CITY LIMITS\CD\SHETS\090001-SS\DWG	1/27/2025 6:17 AM	SHALLOW, ION	W6007CADD SHEET 49	
LAYOUT NAME: 62				

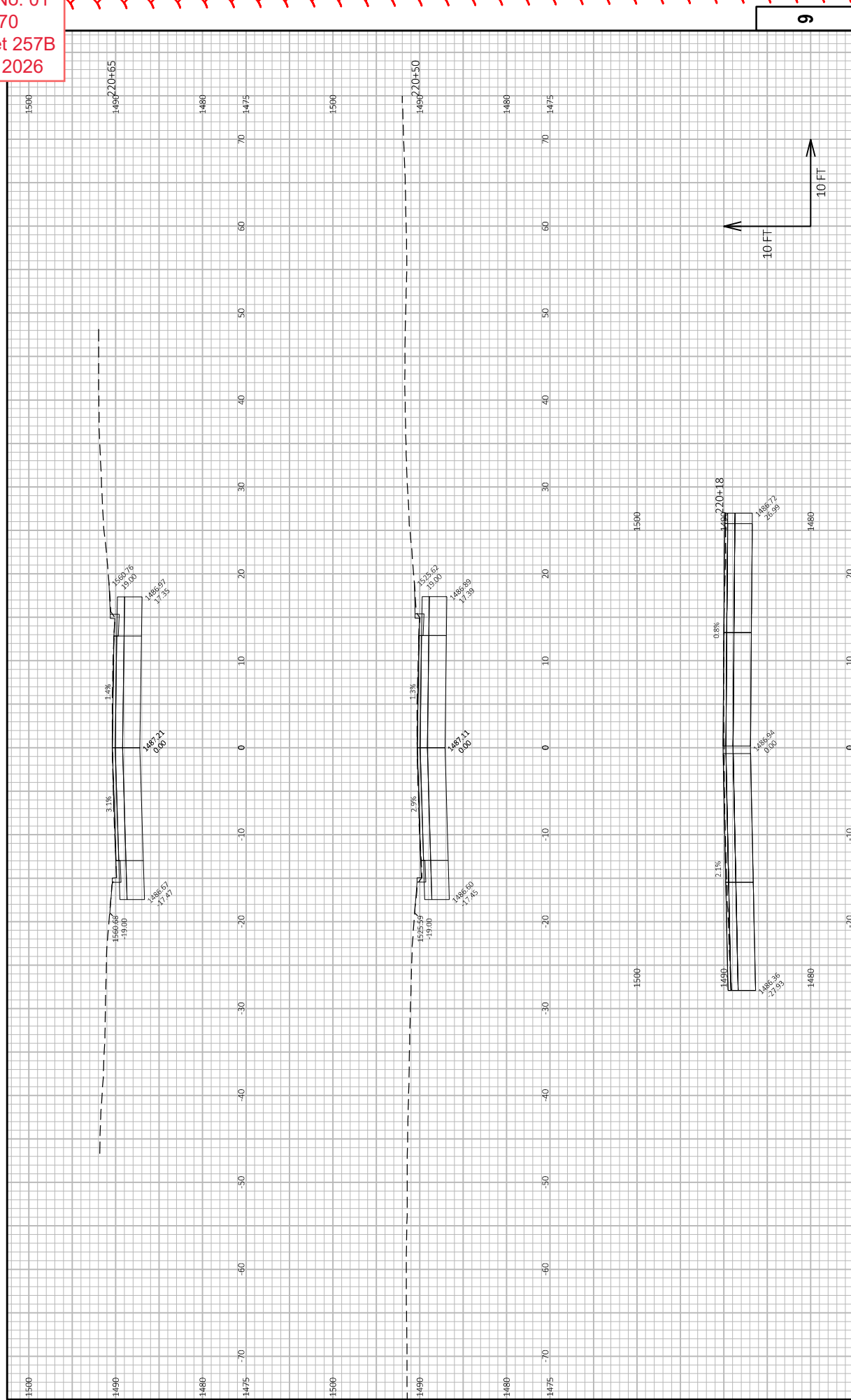

Addendum No. 01
ID 9835-06-70
Added Sheet 257C
January 30, 2026

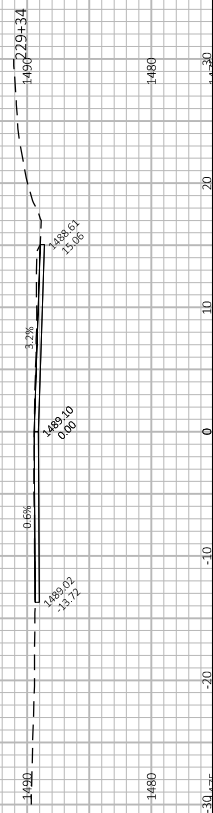
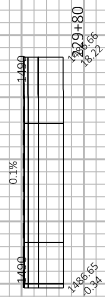

PROJECT NO: 9835-06-70
FILE NAME: I:\35\ANTIGO CITY OF 05-0332.00_ANTIGO 10TH AVE WESTERN AVE - EAST CITY LIMITS\CD\35\050001-SS\DWG
LAYOUT NAME: 64
COUNTY: LANGLADE
CROSS SECTIONS: WAUSAU ROAD
PLOT BY: SHALLOW, ION
PLOT DATE: 1/27/2026 6:17 AM
PLOT SCALE: 1 IN=10 FT HORIZ. / 1 IN=10 FT VERT.

SHEET 257C
E

Addendum No. 01
ID 9835-06-70
Added Sheet 257D
January 30, 2026

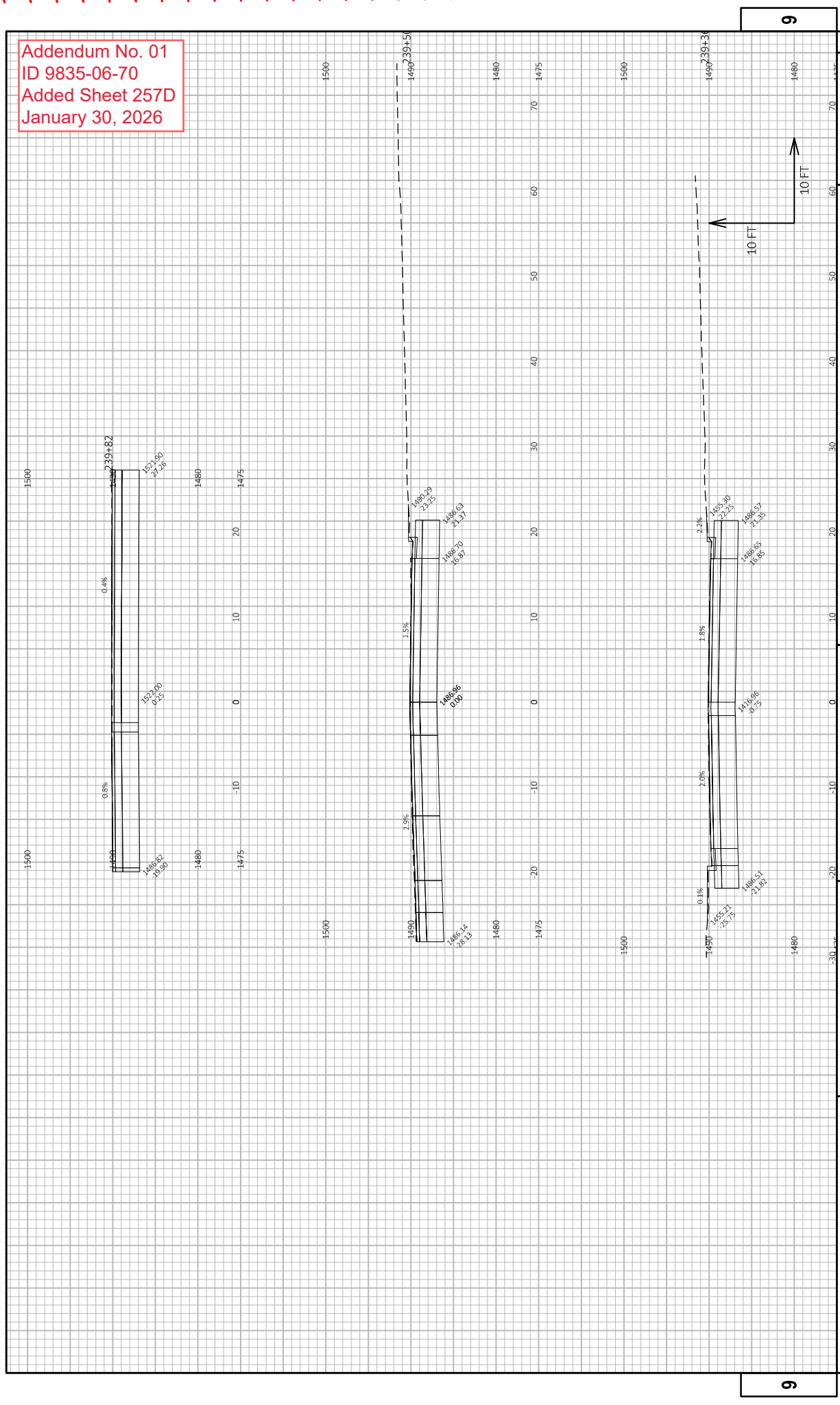



Proposal Schedule of Items

Page 12 of 12

Proposal ID: 20260210034 Project(s): 9835-06-70

Federal ID(s): WISC 2026203

SECTION: 0001

Contract Items

Alt Set ID:

Alt Mbr ID:

Proposal Line Number	Item ID Description	Approximate Quantity and Units	Unit Price	Bid Amount
0324	SPV.0090 Special 10. Water Main Pipe Ductile Iron Class 52, 6-Inch	45.000 LF	_____.	_____.
0326	SPV.0090 Special 11. Water Main Pipe Ductile Iron Class 52, 8-Inch	600.000 LF	_____.	_____.
0328	SPV.0090 Special 12. Water Service Pipe, 1-Inch	90.000 LF	_____.	_____.
0330	SPV.0180 Special 01. Preparing Topsoil For Lawn Type Turf	7,710.000 SY	_____.	_____.
0332	SPV.0180 Special 02. Removing Excess Pulverized Material	24,620.000 SY	_____.	_____.
0334	SPV.0180 Special 03. Hydroseeding	7,710.000 SY	_____.	_____.
0338	SPV.0200 Special 01. Sanitary Manhole 4-ft Diameter	73.400 VF	_____.	_____.
0340	SPV.0200 Special 02. Sanitary Reduction Manhole	20.800 VF	_____.	_____.
0342	SPV.0200 Special 03. Sanitary Manhole Outside Drop	42.600 VF	_____.	_____.
0344	SPV.0195 Special 02. Excavation, Hauling and Disposal of Contaminated Soil and Mgt of Groundwater	685.000 TON	_____.	_____.
Section: 0001			Total:	_____.
			Total Bid:	_____.

