



Wisconsin Department of Transportation

April 3, 2025

Division of Transportation Systems Development
Bureau of Project Development
4822 Madison Yards Way, 4th Floor South
Madison, WI 53705

NOTICE TO ALL CONTRACTORS:

Telephone: (608) 266-1631
Facsimile (FAX): (608) 266-8459

Proposal #08: 1090-03-75, WISC 2025414
IH 43 - Airport Freeway
Hale I/C
IH 43
Milwaukee County

1100-05-73, WISC 2025415
IH 41 Airport Freeway
84th Street to N Lincoln Ave
IH 41
Milwaukee County

Letting of April 8, 2025

This is Addendum No. 03, which provides for the following:

Special Provisions:

Table with 2 columns: Article No., Description. Row 1: 3, Prosecution and Progress

Schedule of Items:

Table with 6 columns: Bid Item, Item Description, Unit, Proposal Total Prior to Addendum, Proposal Quantity Change (-), Proposal Total After Addendum. Row 1: 204.0100, Removing Concrete Pavement, SY, 1,200, -1,164, 36

Plan Sheets:

Table with 2 columns: Plan Sheet, Plan Sheet Title (brief description of changes to sheet). Rows: 33, Construction Details - Added a detail for the special concrete joint repair; 53-54, Removal Plan - Revised 'Removing Concrete Pavement' to 'Concrete Pavement Replacement SHES'; 478, Miscellaneous Quantities - Revised 'Removing Concrete Pavement' quantity

The responsibility for notifying potential subcontractors and suppliers of these changes remains with the prime contractor.

Sincerely,

Mike Coleman

Proposal Development Specialist
Proposal Management Section

**ADDENDUM NO. 03**  
**1090-03-75 & 1100-05-73**  
**April 3, 2025**

**Special Provisions**

**3. Prosecution and Progress.**

*Replace entire section titled Rusty Patched Bumblebee (**Bombus affinis**) with the following:*

**Rusty Patched Bumblebee (*Bombus affinis*)**

The Rusty Patched Bumblebee (RPBB) is a federally listed endangered species. The project will involve access to several existing bridges resulting in temporary ground disturbance. Ground disturbance activities that impact suitable habitat, such as closed canopy wooded areas, shall occur only during the bee's active season, between April 10th and October 10th to avoid the overwintering period for nesting queens and accidental take of the species. Conservation measures shall be taken to re-vegetate disturbed areas outside of the wetlands with a native wildflower seed mix that would benefit the RPBB in the area and provide improved foraging opportunities relative to the existing condition.

Tree clearing will be completed by others prior to work beginning. The contractor is responsible for removing the cut trees within the right-of-way. Tree removal is incidental to the grubbing item.

**Schedule of Items**

Attached, dated April 3, 2025, are the revised Schedule of Items Page 1.

**Plan Sheets**

The following 8½ x 11-inch sheets are attached and made part of the plans for this proposal:  
Revised: 33, 53, 54 and 478.

END OF ADDENDUM

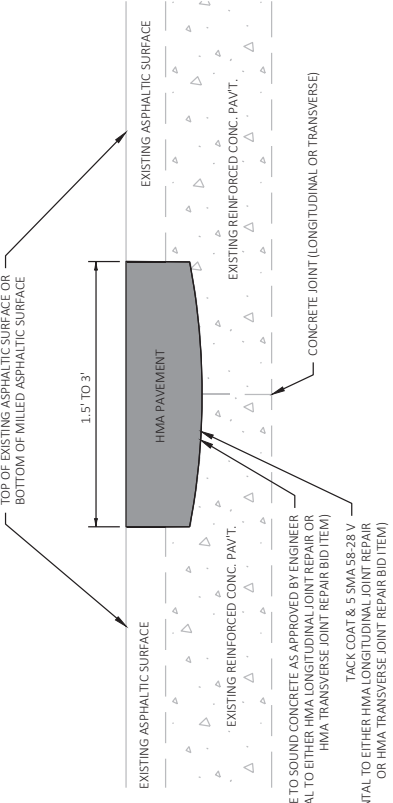

**HMA LONGITUDINAL JOINT REPAIR & HMA TRANSVERSE JOINT REPAIR**

- NOTES**
- 1) IN ALL AREAS OF JOINT REPAIR, REMOVE ASPHALTIC MATERIAL AND/OR LOOSE, DETERIORATED CONCRETE. CLEAN AND REPLACE WITH HMA PAVEMENT AS DIRECTED BY THE ENGINEER.
  - 2) LOCATIONS FOR JOINT REPAIR TO BE APPROVED BY THE ENGINEER PRIOR TO THE START OF REPAIR WORK.
  - 3) ACTUAL WIDTH TO BE DETERMINED BY THE ENGINEER.

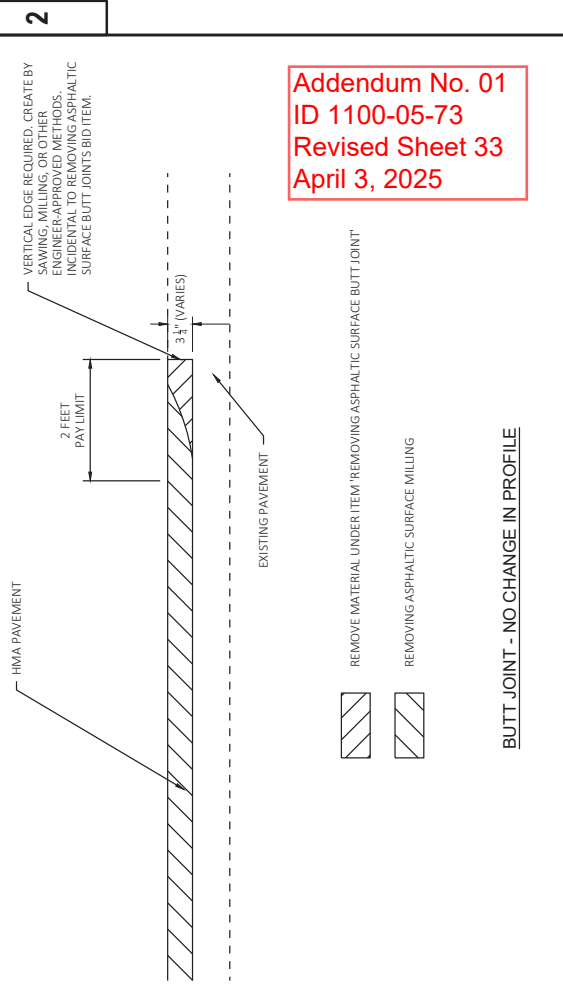

Addendum No. 01  
ID 1100-05-73  
Revised Sheet 33  
April 3, 2025

**BUTT JOINT - NO CHANGE IN PROFILE**

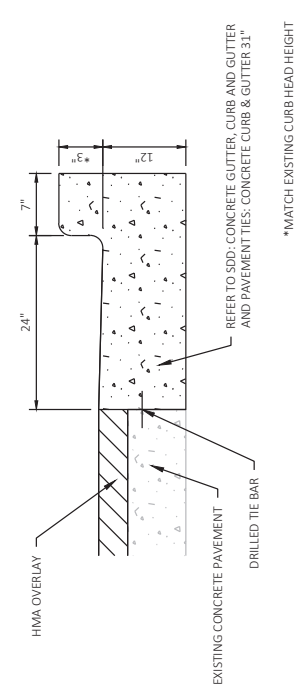

**CONCRETE CURB & GUTTER 31-INCH, MODIFIED**

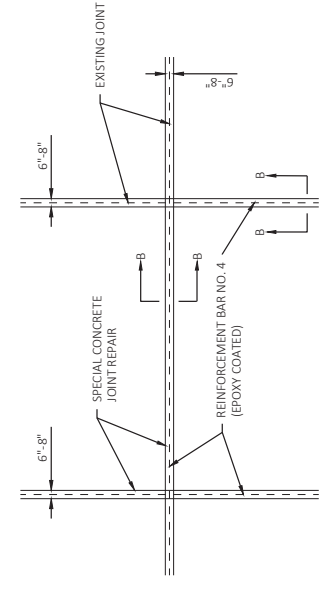

**PLAN VIEW**

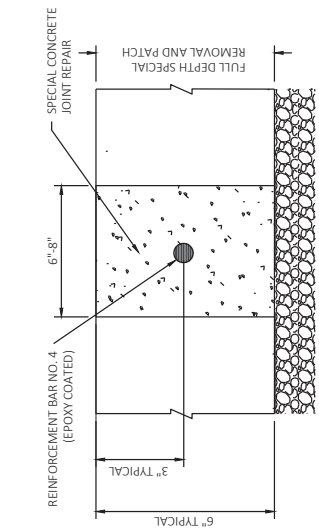

**SECTION B-B**

**SPECIAL CONCRETE JOINT REPAIR  
PARK & RIDE LOT**

- NOTES:**
- PAYMENT FOR REINFORCEMENT BAR NO. 4 SHOWN IN THIS DETAIL SHALL BE PAID BY THE CONTRACTOR.
  - JOINTS REQUIRING REPAIR SHALL BE DETERMINED IN THE FIELD BY THE ENGINEER.



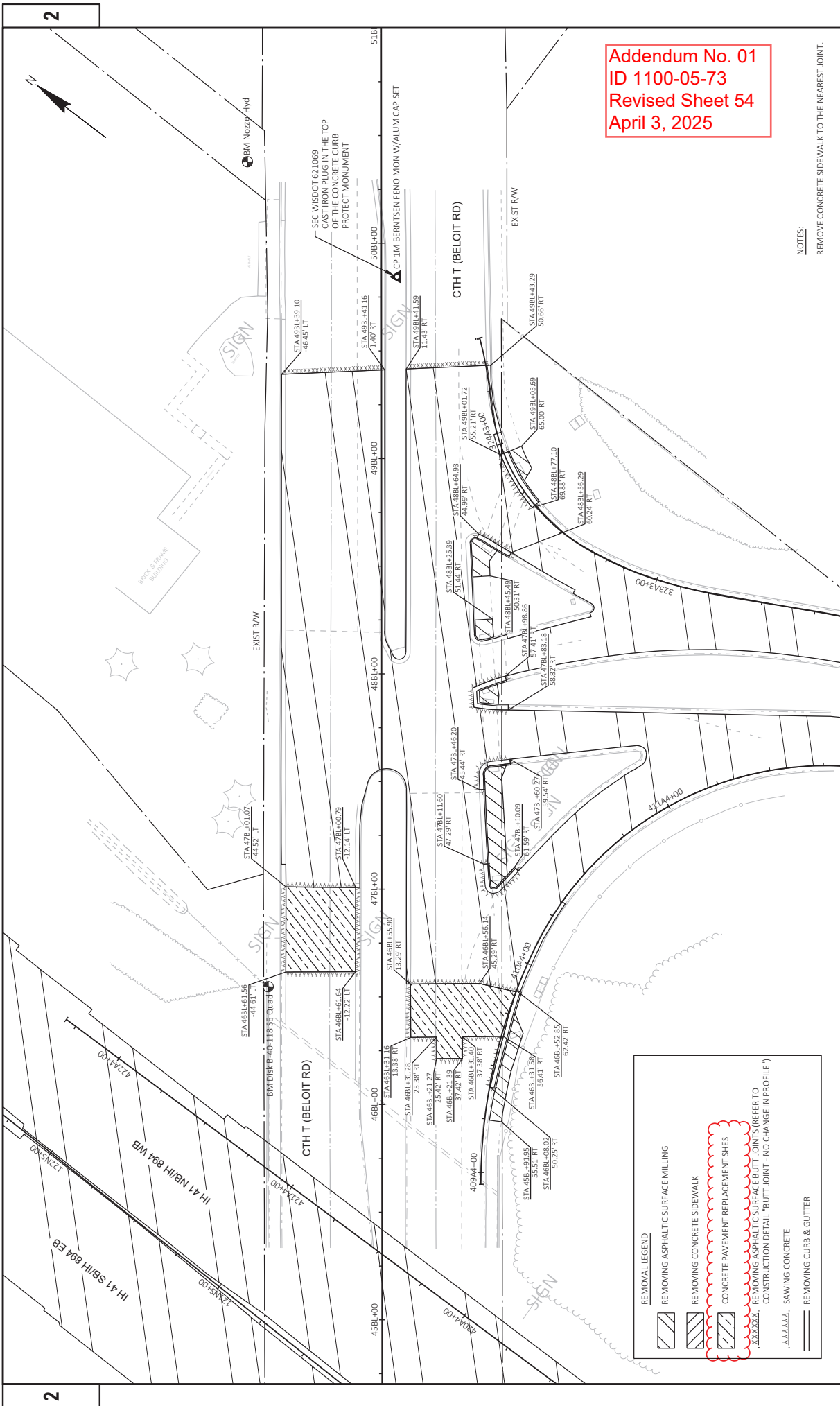

Addendum No. 01  
 ID 1100-05-73  
 Revised Sheet 54  
 April 3, 2025

NOTES:  
 REMOVE CONCRETE SIDEWALK TO THE NEAREST JOINT.

REMOVAL LEGEND	
	REMOVING ASPHALTIC SURFACE MILLING
	REMOVING CONCRETE SIDEWALK
	CONCRETE PAVEMENT REPLACEMENT SHES
	REMOVING ASPHALTIC SURFACE BUT JOINTS (REFER TO CONSTRUCTION DETAIL - BUTT JOINT - NO CHANGE IN PROFILE)
	SAWING CONCRETE
	REMOVING CURB & GUTTER

Addendum No. 01  
 ID 1100-05-73  
 Revised Sheet 478  
 April 3, 2025

3

CATEGORY	STAGE	STATION	TO	STATION	LOCATION	204.0100	204.0115	204.0120	204.0126.5	204.0150	204.0155	204.0165	204.0190	204.0195	204.9180.5.001	REMARKS
1000	2A	25+98.87 RENB	-	82+95 EW	1894-HALE INTERCHANGE (SEGMENT 1)	REMOVING CONCRETE PAVEMENT SY	21	36,992	--	--	--	186	--	--	--	OUTSIDE LANES
	2B					REMOVING ASPHALTIC SURFACE BUTT JOINTS SY	21	37,009	--	--	--	--	--	--	--	INSIDE LANES
	3B					REMOVING ASPHALTIC SURFACE MILLING SY	--	--	9,630	--	--	--	--	--	--	
	N/A					REMOVING ASPHALTIC SURFACE MILLING JOINT MILLING LF	--	--	--	--	--	--	1	--	33	RIPRAP CHANNEL & FLUME
	2	74+02.90 NS	-	208+48 NS	1894-HALE INTERCHANGE (SEGMENT 1) SUBTOTAL		42	74,001	9,630	--	--	186	1	--	33	
					1894-NORTH-SOUTH (SEGMENT 2)		25	91,355	--	--	--	83	--	--	--	NB
							24	90,171	--	--	--	278	--	2	--	SB
	1a	40BL454	-	49BL442	1894-NORTH-SOUTH (SEGMENT 2) SUBTOTAL		49	181,526	--	--	--	361	--	2	--	
	1b				BELOIT RD & RAMPS		--	--	--	231	148	--	--	--	--	CURB RAMPS & STAGING
	2						--	--	--	13	8	--	--	--	--	
	FULL CLOSURE						35	12,617	--	--	--	--	--	--	--	
					BELOIT RD SUBTOTAL		35	12,617	--	244	156	--	--	--	--	
	1a	69OK450	-	76OK452	OKLAHOMA AVE & RAMPS		--	--	--	210	102	--	--	--	--	CURB RAMPS
	1b						--	--	--	70	237	--	--	--	--	CURB RAMPS & SIGNAL WORK
	1c						--	--	--	36	21	--	--	--	--	CURB RAMPS
	2						--	--	--	32	--	--	--	--	--	LOOP DETECTORS
	FULL CLOSURE						67	6,458	--	--	--	93	--	--	--	
					OKLAHOMA AVE SUBTOTAL		67	6,458	--	348	360	--	--	--	--	
	FULL CLOSURE	48NT489	-	492C3406	NATIONAL AVE & RAMPS		--	15,451	--	23	--	--	--	--	--	
	1a	42LN461	-	50LN417	LINCOLN AVE & RAMPS		--	--	--	132	43	--	--	--	--	CURB RAMPS
	1b						--	--	--	68	37	--	--	--	--	CURB RAMPS & LOOP DETECTORS
	1c						--	--	--	51	31	--	--	--	--	CURB RAMPS & LOOP DETECTORS
	2						--	--	--	15	--	--	--	--	--	CURB RAMPS
	FULL CLOSURE						32	6,270	--	--	--	--	--	--	--	
					LINCOLN AVE SUBTOTAL		32	6,270	--	266	111	--	--	--	--	
					SEGMENT 3 SUBTOTAL		134	40,796	--	881	627	279	--	--	--	
					CATEGORY 1000 TOTAL		36	296,323	9,630	881	627	826	1	2	33	
1010		1066450	-	1071+00	PARK AND RIDE		--	--	--	124	751	--	--	--	--	PARK AND RIDE LOT
					PROJECT TOTAL		225	296,323	9,630	1,005	1,378	826	1	2	33	

3



Proposal Schedule of Items

Proposal ID: 20250408008 Project(s): 1090-03-75, 1100-05-73

Federal ID(s): WISC 2025414, WISC 2025415

SECTION: 0001 Contract Items

Alt Set ID: Alt Mbr ID:

Proposal Line Number	Item ID Description	Approximate Quantity and Units	Unit Price	Bid Amount
0002	108.4400 CPM Progress Schedule	1.000 EACH	_____.	_____.
0004	203.0211.S Abatement of Asbestos Containing Material (structure) 001. B-40-300	1.000 EACH	_____.	_____.
0006	203.0211.S Abatement of Asbestos Containing Material (structure) 002. B-40-301	1.000 EACH	_____.	_____.
0008	203.0211.S Abatement of Asbestos Containing Material (structure) 003. B-40-302	1.000 EACH	_____.	_____.
0010	203.0220 Removing Structure (structure) 001. B-40-302	1.000 EACH	_____.	_____.
0012	203.0335 Debris Containment Over Waterway (structure) 001. B-40-188	1.000 EACH	_____.	_____.
0014	203.0335 Debris Containment Over Waterway (structure) 002. B-40-304	1.000 EACH	_____.	_____.
0016	203.0335 Debris Containment Over Waterway (structure) 003. B-40-305	1.000 EACH	_____.	_____.
0018	203.0335 Debris Containment Over Waterway (structure) 004. B-40-322	1.000 EACH	_____.	_____.
0020	203.0335 Debris Containment Over Waterway (structure) 005. B-40-323	1.000 EACH	_____.	_____.
0022	203.0335 Debris Containment Over Waterway (structure) 006. B-40-324	1.000 EACH	_____.	_____.
0024	204.0100 Removing Concrete Pavement	36.000 SY	_____.	_____.
0026	204.0115 Removing Asphaltic Surface Butt Joints	225.000 SY	_____.	_____.

