

1

Preferred Alternative: US 51 and WIS 30

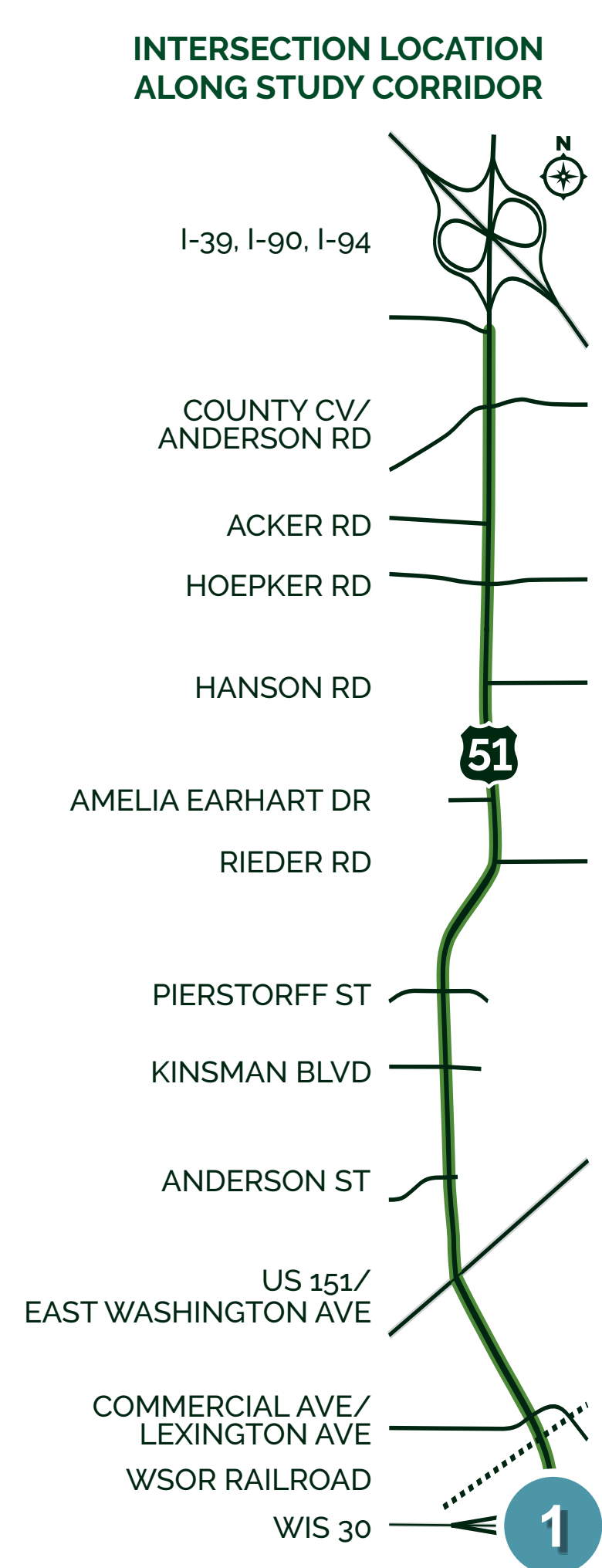
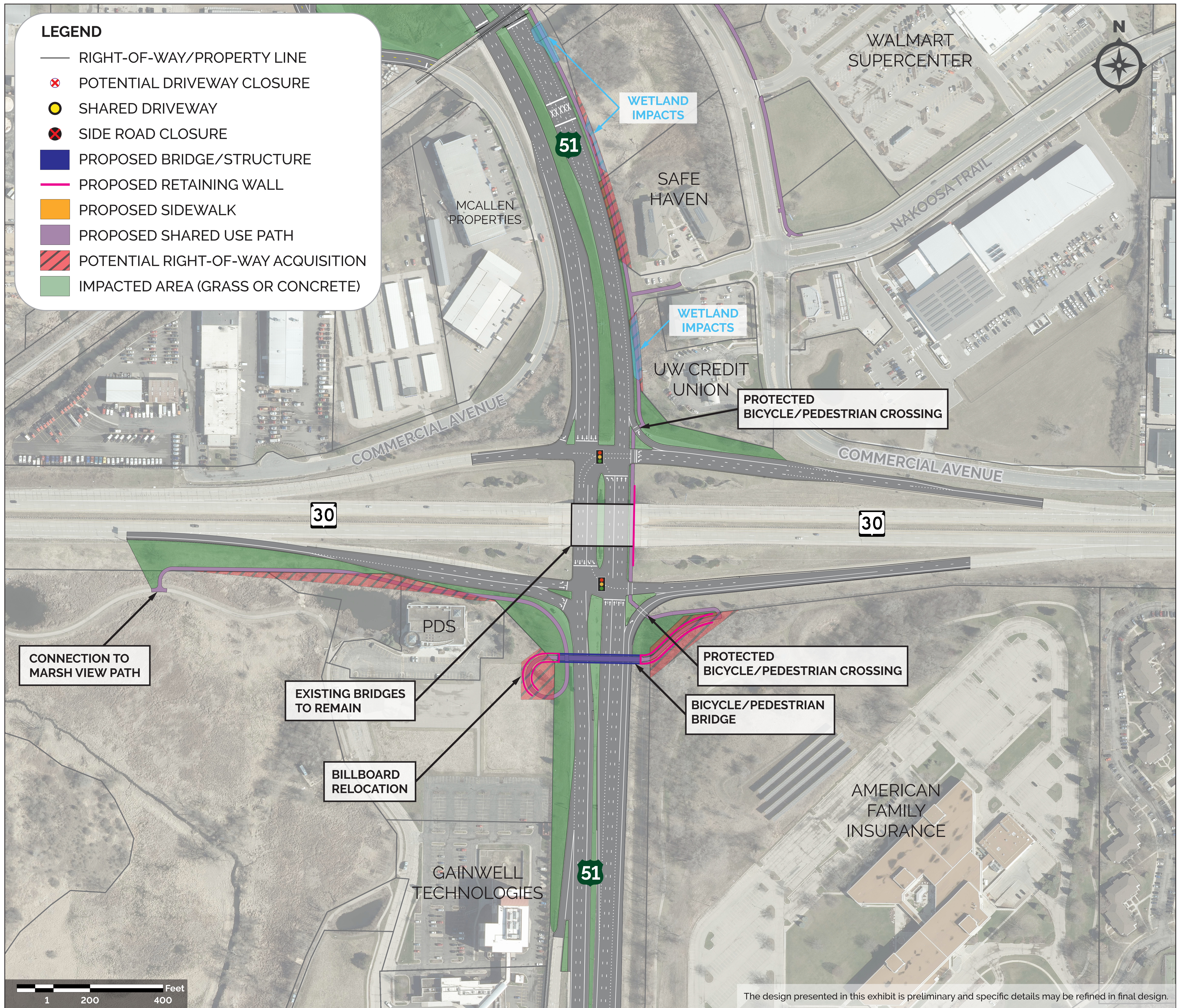

ALTERNATIVE OVERVIEW

INTERCHANGE IMPROVEMENTS

- Maintains existing signalized ramp intersections
- Adds and lengthens turn lanes
- Signalizes eastbound WIS 30 to southbound US 51 right turn
- Northbound and westbound right turns are free-flow movements.

BICYCLE/PEDESTRIAN IMPROVEMENTS

- Shared use path along east side of US 51
- Bicycle/pedestrian bridge over US 51 south of interchange that connects to Marsh View Path★
- Protected pedestrian actuated crossing signal at northbound and westbound right turns.★

ADDITIONAL IMPROVEMENTS

- Adds a northbound auxiliary lane between WIS 30 and Commercial Avenue

★ Updated since Public Involvement Meeting (PIM) #3 - April 2024