



Public Involvement

I-94 & I-39 Bridge Rehabilitation Project

Madison

I-94 Eastbound Over I-90 Northbound & County Highway T

I-39 Westbound & Eastbound Over US151

Dane County

Public Comment Period:

This presentation is for the bridge rehabilitation project on I-94 eastbound bridges over I-90 northbound and County Hwy T & the I-39 west and eastbound bridges over US151 from the City of Madison to the Town of Burke, Dane County, Wisconsin.

An in-person meeting is not planned at this time.

All meeting materials, including the handout with a comment form, are posted on the design website for this project, which can be found at: [I-94 and I-39 bridges](#)

If you have any questions, please contact the WisDOT Project Manager, Mark Sponem at (608) 245-2627 or SEH Design Project Manager, Chris Blum at (608) 620-6192.





Event Objectives

- Project Limits and Definition
- Project Purpose and Need
- Proposed Improvements
- Construction Impacts
- Estimated Project Costs
- Project Schedule
- Contact Information
- Questions and Input



Project Limits and Definition

- This project consists of four bridge rehabilitations:
 - I-94 eastbound over I-90 westbound
 - (B-13-438)
 - I-94 eastbound over County T
 - (B-13-450)
 - I-39 westbound over US151
 - (B-13-451)
 - I-39 eastbound over US151
 - (B-13-452)

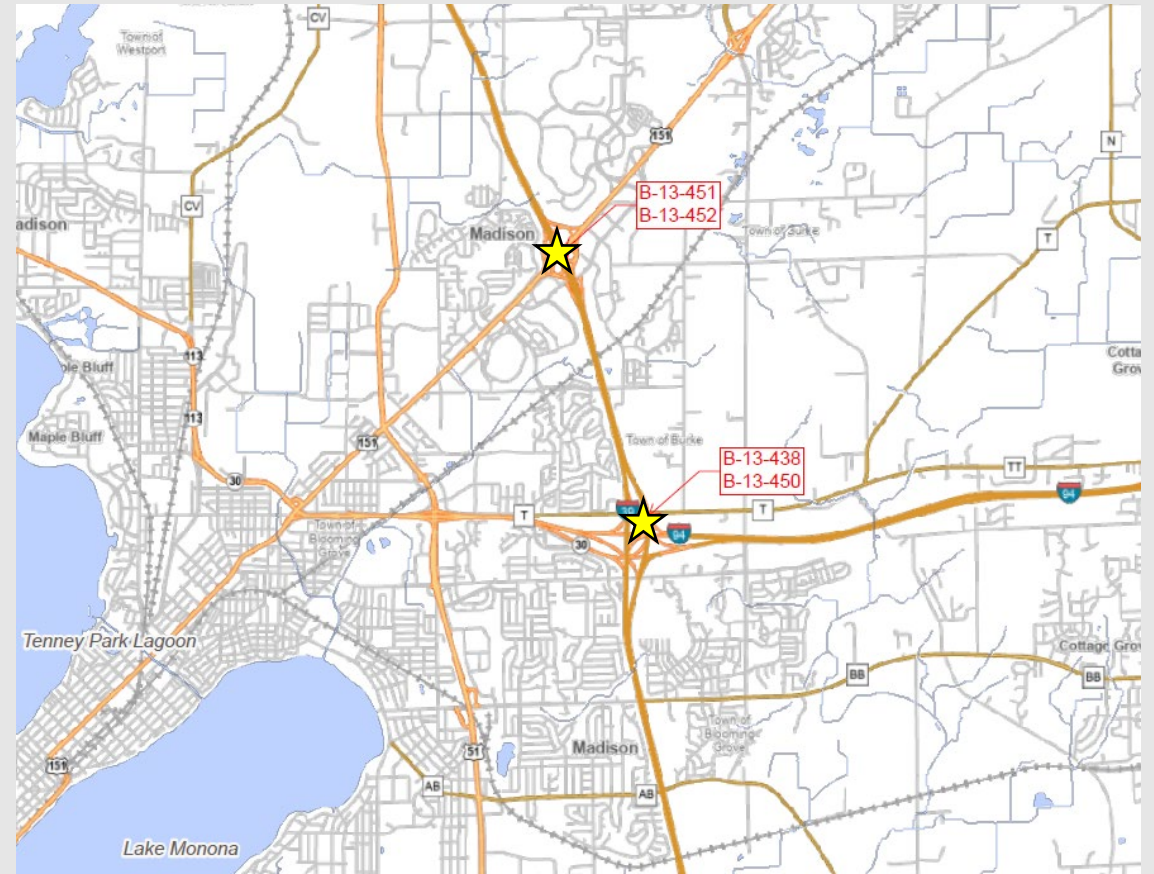

Project Purpose and Need

- Proposed improvements on the bridge would address structural deficiencies of the existing four bridges.



Proposed Improvements

- I-94 eastbound bridge over I-90 westbound scope includes:
 - Expansion joint replacement at each end.
 - Replacement of the approach slabs on each end (not including shoulders).
 - Spot painting of the girder ends at ends of bridge for 10 feet.
 - Guardrail replacement at both sides of the north ends and inside of the south end.



Proposed Improvements

- I-94 eastbound bridge over County Hwy T scope includes :
 - Full replacement of southeast wing, and possibly the northwest wing.
 - Repair of the deck ends on both sides.
 - Replacement of the approach slabs and shoulders at both ends.
 - Guardrail replacement on both sides on the north end and southeast side of exit.



Proposed Improvements

- I-39 bridges over US151 scope includes :
 - Repair of the deck at both ends
 - Replacement of the approach slabs at both ends, not including shoulders.



Construction Impacts

- I-94 eastbound & I-39 east and westbound for the duration of the project (2-3 months):
 - Lane and ramp closures throughout construction.
 - Through traffic access would be maintained.
 - Construction would be staged.



Construction Impacts

- Bridge and roadway work is to be completed in halves to maintain through traffic during construction.
 - Half of the roadway will be closed to traffic while construction improvements are made, with traffic utilizing the other half of the roadway.
 - The newly constructed side would then be opened to traffic while the other half is closed.

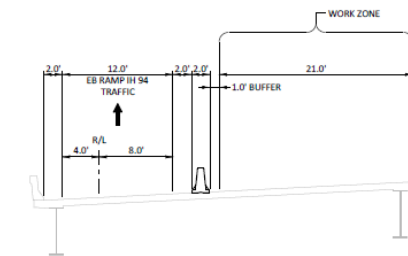

TRAFFIC CONTROL
TYPICAL SECTION - STAGE 1
IH 94 EB (SB TO EB RAMP)
8-13-450/455
STA ____ TO STA ____

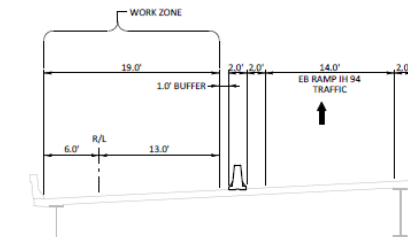

TRAFFIC CONTROL
TYPICAL SECTION - STAGE 2
IH 94 EB (SB TO EB RAMP)
8-13-450/455
STA ____ TO STA ____

Estimated Project Costs

- Estimated Roadway Cost
 - \$1,126,164.00
- Estimated Structure Costs
 - B-13-438: \$185,276.00
 - B-13-450: \$39,884.00
 - B-13-451: \$15,340.00
 - B-13-452: \$26,520.00
- Estimated Total with Engineering
 - \$1,602,200.00



Project Schedule

- Final Design Plan Completion
 - November 2026
- Construction
 - Summer 2029 construction season
 - Work is anticipated to take approximately 45 working days (2-3 months) to complete



Project Team Contact Information

- Alex Hagen, WisDOT Southwest Region
 - WisDOT Project Supervisor
 - (608) 246-3830 or alex.hagen@dot.wi.gov
- Mark Sponem, WisDOT Southwest Region
 - WisDOT Project Manager
 - (608) 245-2627 or mark.sponem@dot.wi.gov
- Chris Blum, SEH
 - Design Consultant Project Manager
 - (608) 620-6192 or cblum@sehinc.com



Questions and Input

- Submit no later than July 25 by:
 - Email to: cblum@sehinc.com
 - Mail to:
Short Elliott Hendrickson, Inc.
6808 Odana Road, Ste 200
Madison, WI 53719
Attn.: Chris Blum

[illegible]