

● SELECT CRUSHED MATERIAL FOR TRAVEL CORRIDOR.

The diagram illustrates a cross-section of a two-lane road. It features two travel lanes, each 12'-0" wide, separated by a centerline. On either side of the travel lanes are paved shoulders, each 6'-0" wide. Arrows indicate the direction of travel for each lane. The total width of the road section shown is 36'-0".

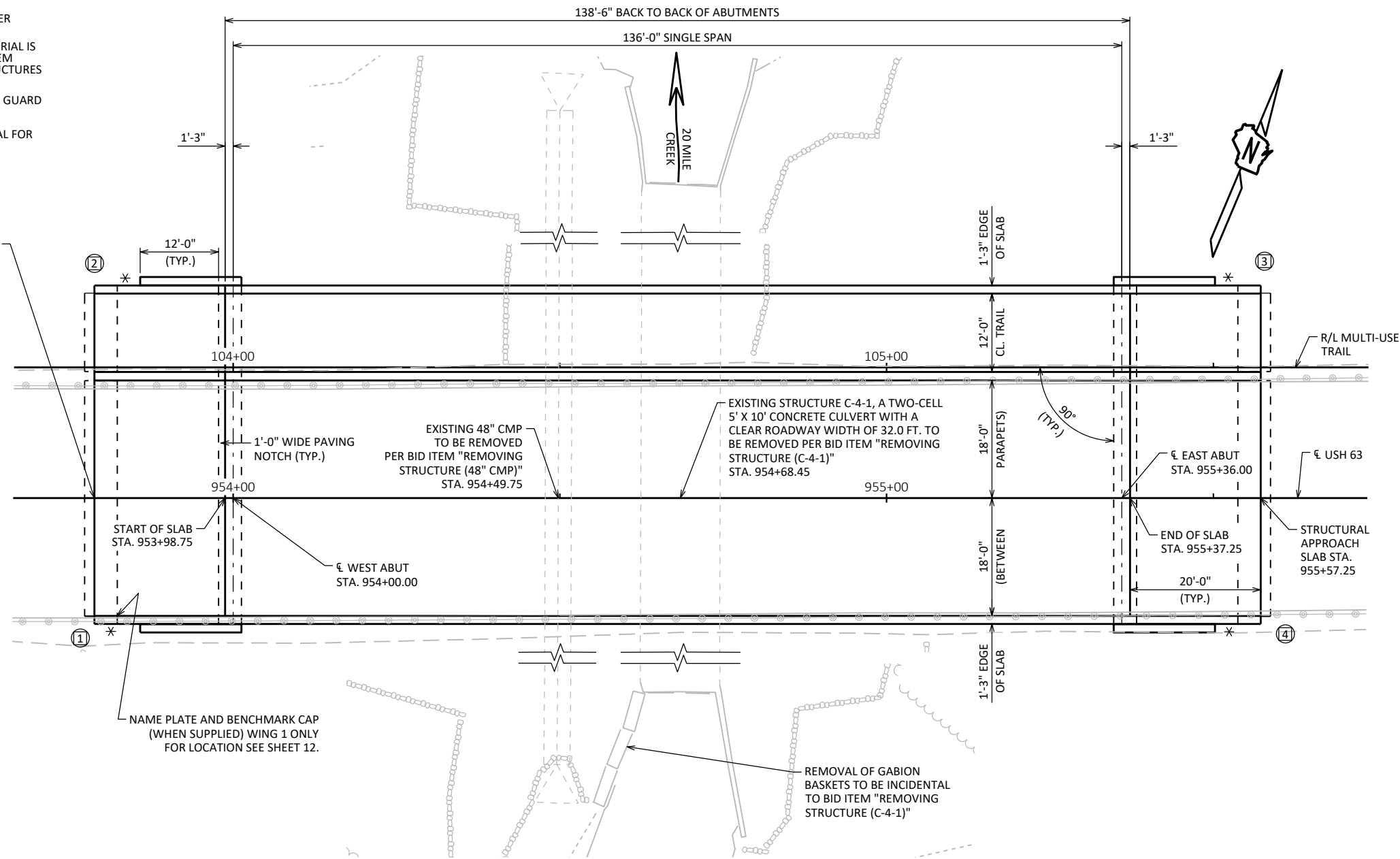

(SINGLE SPAN PRESTRESSED CONCRETE GIRDER BRIDGE)

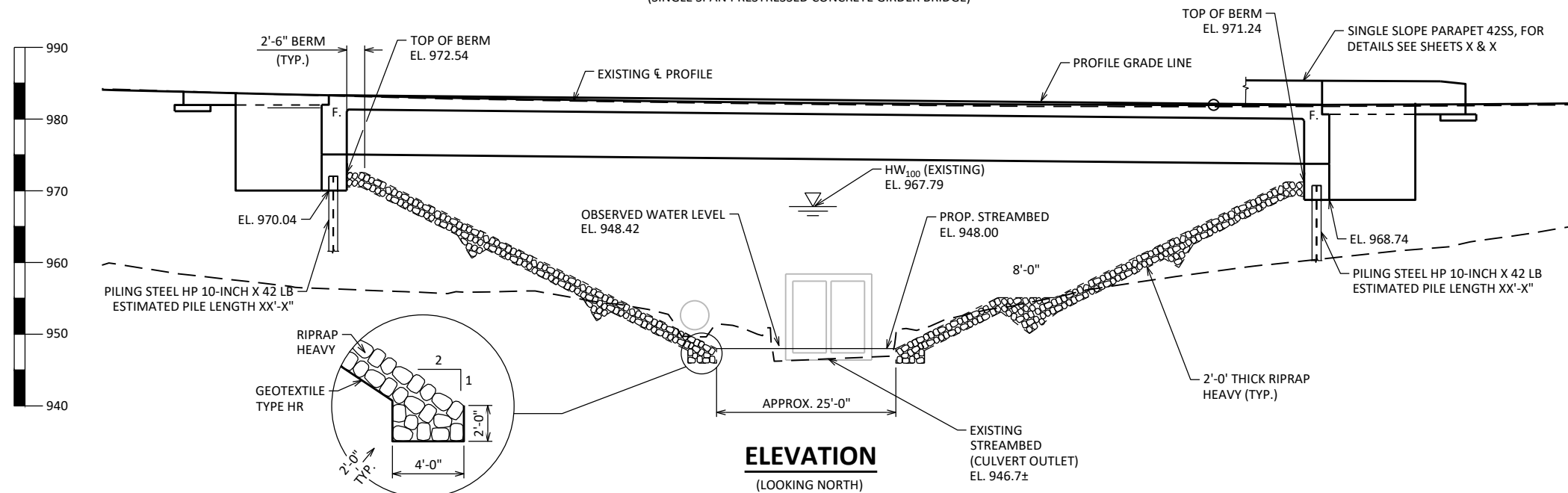

(LOOKING NORTH)

GENERAL PLAN	
--------------	--