



WIS 13/Apache Avenue Intersection

Project ID: 6140-02-02/72

Adams - Wisconsin Rapids

Wisconsin Department of Transportation

Public Involvement Meeting

June 16, 2025

WIS 13 Improvement Plan

- Agenda

- Project Limits
- Project Purpose and Need
- Proposed Design Improvements
- Traffic Control During Construction
- Project Schedule
- Contact Information



Project Limits



Project Purpose & Need

- Purpose

- Maintain a safe and efficient roadway transportation facility along WIS 13

- Need

- Address high crash rates at the Apache Avenue intersection
 - Mainly due heavy southbound right turning movement and eastbound left turning movement.



Proposed Design Improvements

- Turn Lane
 - Southbound offset right turn lane at Apache Avenue intersection



Proposed Design Improvements



Proposed Design Improvements

- Other Improvements
 - Curb and gutter
 - Ditching to improve drainage
 - Installing pavement marking

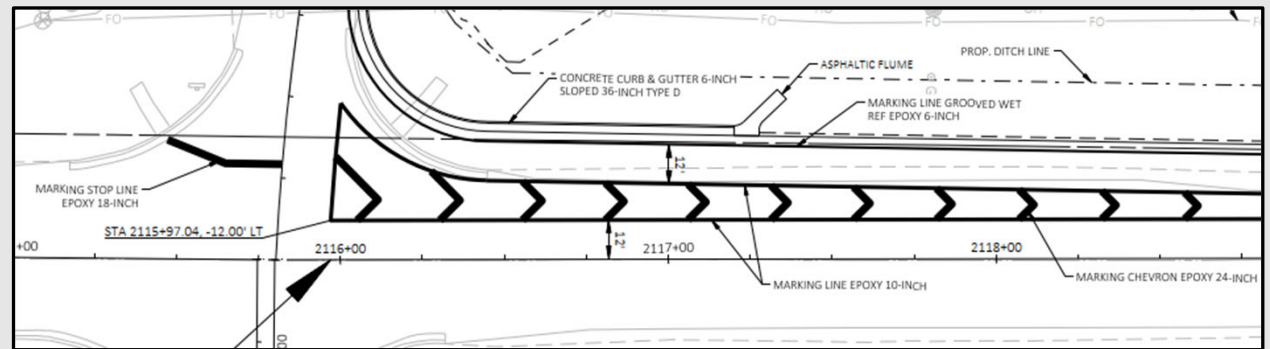

Traffic Control During Construction

- Traffic to be maintained
 - Two lanes maintained (one in each direction)
 - Access to residents, businesses, and emergency vehicles will be maintained during construction
 - No disruptions to transit are anticipated

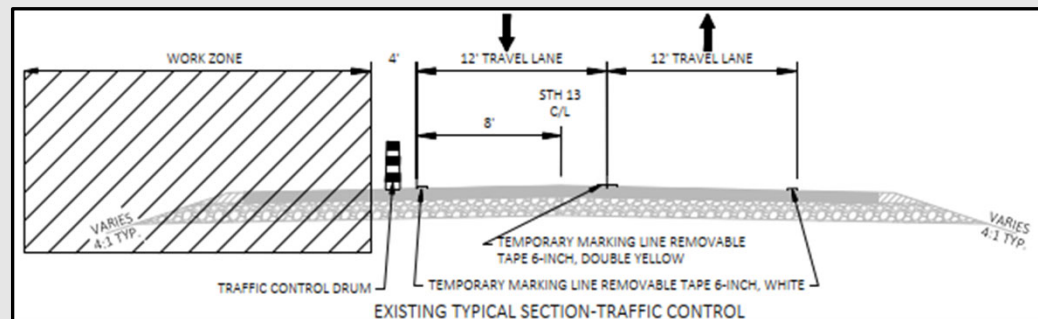

Project Schedule

- Environmental Document July 2025
- Design Study Report November 2025
- 90% Plan March 2026
- Final PS&E May 2026
- Bid Letting October 2026
- Begin Construction Spring/Summer 2027



Contact Information

- WisDOT Project Manager-Elizabeth Miller, PE
 - (715) 315-9237 elizabeth.miller@dot.wi.gov
- Design Consultant-Ryan McKane, PE - WSP USA
 - (608) 385-5307 ryan.mckane@wsp.com



WIS 13 Public Involvement Meeting

Thank you for your time!

If you have any comments, questions, or concerns - please send us an email,
give us a call or send us mail at:

1681 Second Ave South
Wisconsin Rapids, WI 54495

