



# US 10 Pavement Improvements Portage County

Public Involvement Meeting  
Bannach Elementary School, 5400 Walter Street, Stevens Point, WI

**June 18, 2025**

# Agenda

- Project location
- Purpose and need
- Proposed improvements
- Traffic control / traffic impacts
- Real estate impacts
- Contact information



# Project Location

- US 10, Portage County
  - Old Highway 18 Road to County J



# Project purpose and need

## Roadway deficiencies

- Pavement condition
  - Distresses
- Culvert/inlet condition
- Concrete barrier and guardrail condition



# Proposed Improvements

- Concrete pavement repair/replacement
  - US 10, County J and Ramps
- Mill and overlay Two-Way Left Turn Lane (TWLTL)
- Replace existing asphaltic paved shoulders
- Replace curb and gutter in spot locations based on condition
- Repair/Replace existing concrete barrier in median
- Update beam guard on County J



# Proposed Traffic Impacts

- Construction currently anticipated for 2028.
- During construction, motorists can expect single-lane closures or bidirectional traffic.
  - Advanced notification will be given for temporary disruptions to access due construction operations



# Proposed Traffic Impacts

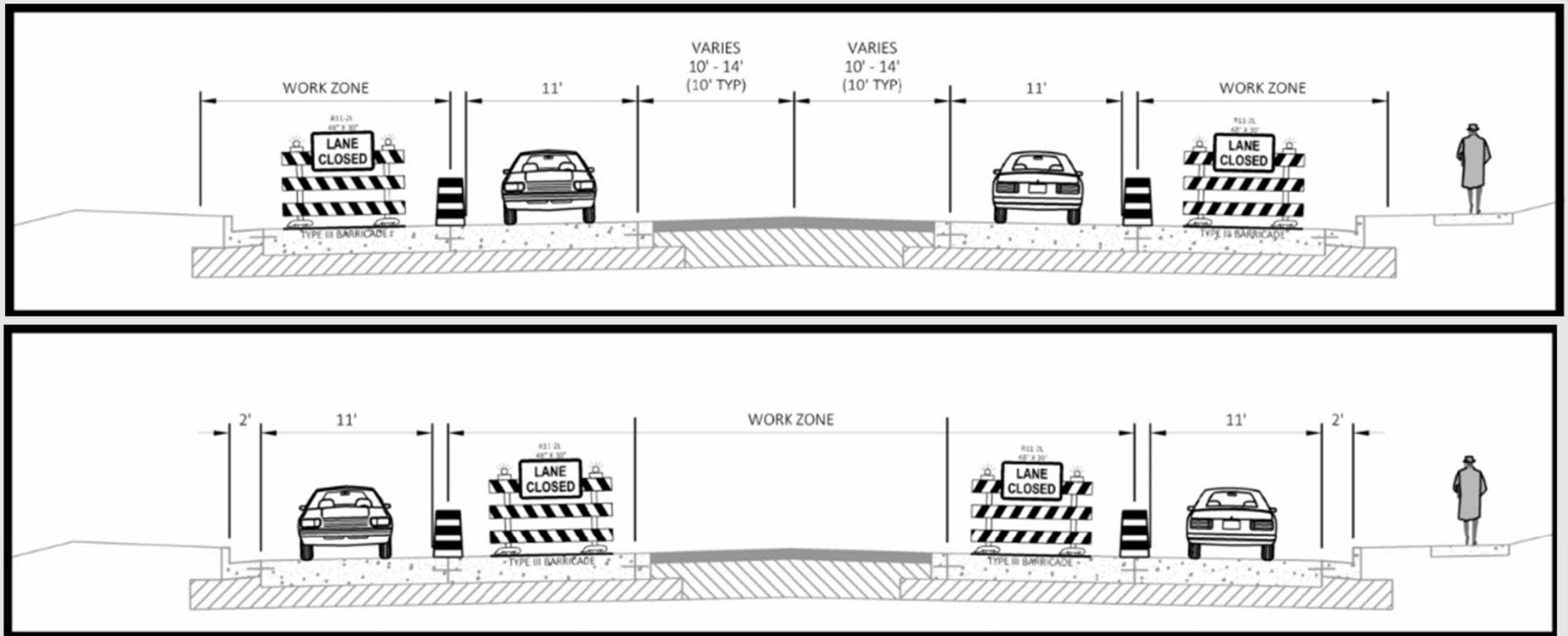

# Proposed Traffic Impacts

- Access maintained to businesses during hours of operation
  - Coordination to determine any opportunities for short-term access closures
- Anticipate short term nighttime closures of ramps at County J interchange





# Real Estate

- Additional right of way is not anticipated



# Contact information

- Provide input by July 11, 2025
  - Complete comment form found in handout
  - Via email or phone



# Contact information

Preston Bohn, P.E.  
Project Manager  
Wisconsin Dept of Transportation  
North Central Region  
1681 Second Avenue South  
Wisconsin Rapids, WI 54495-4768  
(715) 421-7382  
[Preston.Bohn@dot.wi.gov](mailto:Preston.Bohn@dot.wi.gov)

Michael Jelinek  
Project Leader  
Wisconsin Dept of Transportation  
North Central Region  
1681 Second Avenue South  
Wisconsin Rapids, WI 54495-4768  
(715) 421-8098  
[Michael.Jelinek@dot.wi.gov](mailto:Michael.Jelinek@dot.wi.gov)



# Thank you!

