

Public Involvement

**US 10
OLD HWY 18 ROAD TO County J
PORTAGE COUNTY
Project ID: 6290-05-60**

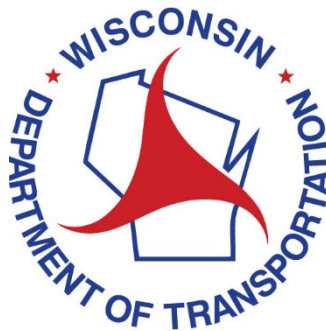

June 18, 2025

Deaf, hard-of-hearing, deaf-blind, and speech-disabled persons should contact the Wisconsin Relay Service for assistance by dialing 711.

Purpose

The reason for the meeting is to share the upcoming US 10 project scope to business owners, the public, and real estate owners along project limits. This communication is planned to aid in answering questions and fulfilling information based on project intentions and plans in 2028. This format also allows feedback and questions to encourage project coordination and discussion.

Project Information

Construction is currently scheduled to begin in the Spring of 2028. We are proposing to improve 4.125 miles of US 10 in Stevens Point.

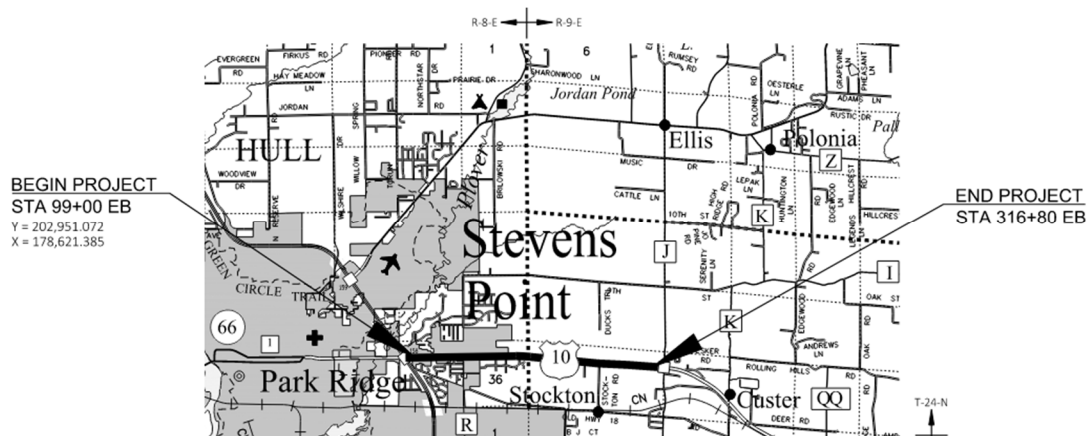

The existing US 10 Eastbound and Westbound pavement between I-39/US 51 and County J, as well as County J and the associated ramps, is showing signs of distress with low and medium severity longitudinal cracking along with weathering of the pavement surface. The existing cracks allow water and de-icing chemicals to enter the pavement and accelerate the deterioration of the roadway. This roadway will continue to deteriorate and fall below the recommended pavement quality if actions are not taken to enhance the existing roadway.



Two different levels of pavement work are planned to address the identified problem areas along this roadway.

Concrete Pavement Replacement

- For the areas that are identified as having the worst condition, a full depth concrete pavement repair and replacement is scheduled.

Continuous Diamond Grinding Concrete Pavement

- Areas where joints and roadways are starting to show distress- they can be rehabilitated using a continuous diamond grinding technique across the surface. This approach will allow the least destructive approach to repair areas of the least concern.

Together, these two approaches plan to improve and extend the life of the roadway beyond its current estimate. This work would also be completed on the ramps at the County J interchange as well as County J between the ramp terminals.

Additional/ Incidental Work

- The existing asphaltic pavement Two-Way Left Turn Lane (TWLTL) will have the pavement surfaced milled and replaced with new asphaltic pavement.
- The existing asphalt pavement shoulders would be replaced with new asphalt pavement.
- The inlets along the roadway would have repairs completed based on condition.
- Some existing pipes would be removed and replaced in kind based on condition.
- Curb and gutter areas would be evaluated based on condition and replaced in kind.
- The existing concrete barrier in the median of US 10 near the County J interchange is anticipated to be repaired/replaced.
- The beam guard approaches to the County J structure over US 10 would be replaced to meet current design standards.

No other safety, parking, or roadway improvements are planned at this time outside of the previously mentioned.

Construction is currently scheduled for completion in Fall 2028.

Public Input

If there is any public input into the proposed improvements, we are open to discussing. If there is additional information that would like to be included there will be a public input/comments sheet to be filled out and submitted online or in the mail.

Proposed traffic impacts

Construction is currently scheduled to begin in the Spring of 2028

The proposed work can be performed while traffic is maintained on US 10. The construction zone will require temporary lane closures directing traffic to use the other lane or lanes as necessary. Temporary signal timings are anticipated to reduce delays. The ramps between US 10 and County J will be closed for nighttime work. Additional traffic information will be added as the traffic management plan is developed.

Temporary driveway closures may be necessary during parts of the construction process. WisDOT will contact homeowners and businesses in advance before closing a driveway. Access will always be available during hours of operation. Coordination with Businesses will be done to determine if there is any opportunity for short term access closures to reduce construction time.

Real estate

No Real estate is anticipated to be acquired for this project.

Project update/next steps

Public involvement	June 18, 2025
Preliminary plans	Oct. 1, 2025
Environmental document	Oct. 1, 2025
Final right of way plat	N/A
Real estate negotiations	N/A
Final plans	Aug. 1, 2027
Construction currently scheduled	2028

Public input/comments

Your comments assist us in developing a project that will serve the needs of the traveling public as well as the needs of the local community. Your input is welcome and appreciated throughout the design process.

There are several ways to submit your input by **July 11, 2025**:

1. Fill out the comment form attached to this handout and mail it to WisDOT
2. Email comments or questions to the contact(s) listed below

Deaf, hard-of-hearing, deaf-blind, and speech-disabled persons should contact the Wisconsin Relay Service by dialing 711.

For more information, please contact:

Michael Jelinek
WisDOT Project Leader
Wisconsin Department of Transportation, North Central Region
1681 Second Avenue South

Wisconsin Rapids, WI 54495
715-421-8098
Michael.Jelinek@dot.wi.gov

Make sure comment form and postage page are printed front/back.

If needed, insert a blank page here with the following words left:

This page left intentionally blank.



In This Together Program

A quick guide to help your business prepare for road construction

1 ORGANIZE EARLY



- Learn more about the project and its timeline
- Develop questions for WisDOT staff
- Check in with neighboring businesses and/or local business organization



- *Can you partner on promotions, events or materials?*
- *Establish a point of contact for the business community?*

2 STAY ENGAGED WITH THE PROJECT



- Attend public involvement meeting(s)
- Make note of contact information for the project team, and voice the unique needs of your business
- Learn more about project resources



- *Is there a construction website?*
- *Is there a mailing list?*
- *Is there an email distribution?*

3 HELP CUSTOMERS FIND YOU



- Consult with project staff to determine when and where there may be closures or detours
- Ask about temporary signage options
- Consider how best to inform customers



- *Maybe a joint communication with neighboring businesses for employees and customers about traffic and parking?*
- *Maybe a feature article in a customer-facing newsletter?*
- *Maybe a social media post shared by businesses and local community pages?*

4 DEVELOP AND ACTIVATE YOUR GAME PLAN



- Check out case studies at wisconsin.gov/together
- Connect with project contacts to discuss any potential obstacles specific to your business such as deliveries, operational hours, employee parking, etc.
- Check in with employees



- *Is there a consistent message for customers?*
- *Are there temporary changes to shift times, parking, or deliveries?*

5 END OF CONSTRUCTION



- Stay positive, be flexible and know that WisDOT staff are available to help
- Collect any temporary signage
- Let customers know!



- *Consider working with other businesses on a special event?*
- *Share social media about the project's benefits?*
- *Ask customers to help spread the word?*



Remember, we are In This Together! For more planning ideas, tips and resources: wisconsin.gov/together

Public Involvement Comment Form

PROJECT ID 6290-05-60
US 10
OLD HWY 18 ROAD TO County J
PORTAGE COUNTY

(June 18, 2025)

Please place this form in the comment box or mail by July 11, 2025 to the address on the back of this sheet. Comments can also be e-mailed to Michael.Jelinek@dot.wi.gov. Your comments assist us in developing a project that will serve the needs of the traveling public as well as the needs of the local community. Your input is welcome and appreciated throughout the design process.

Name: _____

Address: _____

Phone Number (optional): _____

Email Address (optional): _____

Would you like a response to your comments? Yes ____ No ____

Please Print Comments (attach additional sheets if necessary)

This image shows a single sheet of white paper with horizontal blue or grey ruling lines. The lines are evenly spaced and run across the width of the page. There are approximately 20 lines visible. The paper has a slight shadow on its right side, suggesting it's resting on a surface.

The information in this document including names, addresses, phone numbers, email addresses, and signatures is not confidential, and may be subject to disclosure upon request, pursuant to the requirements of the Wisconsin open records law, sections 19.31 - 19.39 of the Wisconsin Statutes.

Fold here

Place
Stamp
Here

Attn: Michael Jelinek
WisDOT North Central Region
1681 Second Avenue South
Wisconsin Rapids, WI 54495

To mail, fold here and tape.