

16-inch Pedestrian Signal



Features

- Meets or exceeds ITE specifications.
- Design provides minimum weight but maximum rigidity and strength.
- The housing is designed to work with a gasket supplied by LED manufacturer.
- Mounting is completely compatible with all standard signal hardware.
- The housing is designed to accommodate 16-inch LEDs.
- Heavy duty .250" thick material.

Aluminum Signal

The 16-inch Aluminum Pedestrian Signal LED housing is one piece die-cast aluminum alloy, with two integrally-cast hinge lugs, screw slots, and openings at each end. The swing-down door is a single piece die-cast aluminum alloy, with two hinge lugs cast on the top of the door and two latch points on the bottom. The door is attached to the bottom of the housing using two hinge pins. Two eye bolts and wing nuts on the top allow the door to be opened and closed without the need for special tools.

Polycarbonate Signal

The Polycarbonate 16-inch Pedestrian Signal is available in three different colors, yellow, black and green. The LED housing is one-piece injection-molded with hinge lugs, screw slots, and openings at each end. The swing-down door is a single piece injection-molded polycarbonate, with two hinge lugs molded on the bottom of the door and two latch points on the bottom. The door is attached to the bottom of the housing using two cotterless locking pins. Two eye bolts and wing nuts on the top allow the door to be opened and closed without the need for special tools.



Eagle Traffic Control Systems continues our 80+ year history of providing excellence in the ever evolving traffic industry. All of Eagle's products are developed with the highest standards of engineering and manufacturing. Eagle maintains a superior level of integrity in interactions with all of our business partners and customers. We also take tremendous pride in being model corporate citizens.

16-inch Pedestrian Signal



Signal Housing

The openings will accommodate standard 1.5" pipe brackets. The bottom opening of the housing has an integrally-cast locking boss. The radial angular grooves of the locking boss provide 5 degree incremental positioning of the signal to eliminate rotation or misalignment of the signal. The housing is available with a knock-out plug at the top and bottom. This plug eliminates the need for additional hardware to close these openings when using a clamshell or post-top mounting bracket.

Visor Options

The egg crate visor option is designed to eliminate sun phantom and minimize damage to the LED. The egg crate visor is inserted through the back side of the door and it overlaps by 1/2". It is sealed when the door is closed, which prevents light from escaping between the visor and the door. The egg crate visor is available only in black. A tunnel visor is also available to be included either with or without the egg crate visor.

Visor Notes

- When ordering egg crate visor, use Visor color designator F.
- When ordering assembly without Visor, use Visor type 0.

Aluminum Signals Only

- Clamshell installation reference is facing the front of the signal.
- If ordered with Clamshell attached, only the side with the clamshell is drilled.
- If ordered without Clamshell attached, both sides will have 5 holes with knockouts in place.
- Peds are shipped without a door gasket or LED locking device.
- Serrations located on top and bottom.

Polycarbonate Signals Only

- Clamshell installation reference is facing the front of the signal.
- If ordered with Clamshell attached, only the side with the clamshell is drilled.
- If ordered without Clamshell one side will have 5 holes with knockouts in place.
- Peds are shipped without a door gasket or LED locking device.
- Serrations located on top and bottom.
- When ordering black poly housings or doors, use color designator B. Flat Black is not a color option on polycarbonate signals.

16" Ped Parts	Poly	Aluminum
Housing	6.3 lbs.	8.5 lbs.
Door	1.5 lbs.	2.0 lbs.
Tunnel Visor	1.0 lbs.	1.4 lbs.
Egg Crate	2.0 lbs.	2.0 lbs.

16-inch Pedestrian Signal



EAGLE
Traffic

Signal Head Ordering – 16" Pedestrian Aluminum and Polycarbonate

Signal Shape 16" PED	Housing Type	Lens Configuration*	Housing/ Door Material	Clamshell	LED Supplied By	Visor Type	Housing Color	Door Color	Visor Color	LED
SG7 = EAGLE	S = STD	A = Hand/Man	1 = Poly/Poly	0 = None	0 = None	0 = None	0 = No Housing	0 = No Door	0 = No Visor	10
	M = MAINT	B = Walk/Don't	2 = Alum/Alum	1 = Right	1 = Eagle	1 = Egg	A = Aluminum Gray	A = Aluminum Gray	A = Aluminum Gray	
	B = Both	C = SM/WM/CD	3 = Poly/Alum	2 = Left	A = Dialight	2 = Alum Tunnel	B = Gloss Black	B = Gloss Black	B = Gloss Black	
		D = Canada	4 = Alum/Poly		B = Dialight XTE	3 = Poly Tunnel	C = Berkley Brown	C = Berkley Brown	C = Berkley Brown	
		E = Canada			C = Customer	4 = McCain Alum 11"	D = MDC Gray	D = MDC Gray	D = MDC Gray	
		F = Count Down			F = Dialight USA	5 = MoboTrex Alum 11"	E = Battleship Gray	E = Battleship Gray	E = Battleship Gray	
		G = Hand/CD			G = Dialight 48V	6 = MoboTrex Alum 9"	F = Flat Black	F = Flat Black	F = Flat Black	
		H = H/M+CD			J = GE Specific		G = West Coast Green	G = West Coast Green	G = West Coast Green	
		Z = Customer Supplied					H = Minneapolis Yellow	H = Minneapolis Yellow	H = Minneapolis Yellow	
		0 = None					J = Texas Brown	J = Texas Brown	J = Texas Brown	
							L = Ocean State Green	L = Ocean State Green	L = Ocean State Green	
							M = East Coast Green	M = East Coast Green	M = East Coast Green	
							N = Bare	N = Bare	N = Bare	
							P = Quebec Brown	P = Quebec Brown	P = Quebec Brown	
							Q = Bronze (Retardo)	Q = Bronze (Retardo)	Q = Bronze (Retardo)	
							R = Wine Red	R = Wine Red	R = Wine Red	
							S = Star Dust Silver	S = Star Dust Silver	S = Star Dust Silver	
							T = Toronto Gray	T = Toronto Gray	T = Toronto Gray	
							V = VStanley – NY Green	V = VStanley – NY Green	V = VStanley – NY Green	
							W = White (Navajo)	W = White (Navajo)	W = White (Navajo)	
							Y = Yellow	Y = Yellow	Y = Yellow	
							Z* = Special	Z* = Special	Z* = Special	
							X# = Non-Standard for Poly (minimums apply)	X# = Non-Standard for Poly (minimums apply)	X# = Non-Standard for Poly (minimums apply)	

STD - Standard MAINT - Maintenance

Notes

When ordering Maintenance housing WITHOUT clamshell installed, BOTH sides of housing will have mounting holes drilled with removable plugs inserted.

When ordering Maintenance housing WITH clamshell installed, mounting holes will be drilled only on the side the clamshell is installed.
Egg Crate visors available in flat black ("F") only.



A

Hand/Man



B

Walk/
Don't Walk



C

Standing Man
Walking Man
Count Down



D

Canadian
Standing Man
Walking Man
Count Down



E

Canadian
Walking Man
Hand



F

Count Down



G

Hand
Count Down



H

Hand/Man
Count Down

*All renderings are for reference only

mobotrex
MOBILITY & TRAFFIC EXPERTS

SG Polycarbonate d Vehicle Traffic Signal



EAGLE[®]
Traffic Control Systems

Description

The standard signal is composed of three polycarbonate LED-ready body sections containing the door and visor. The basic construction design provides minimum weight but maximum rigidity and strength. The housing, door and visor are injection molded of ultraviolet stabilized, pre-colored opaque polycarbonate. It meets or exceeds ITE specifications.

Features

using – One piece unit with serrations in 5° increments at each end. Each housing has provisions for mounting two terminal blocks and attaching backplates. Housings may be fastened together to make multi-section signals. The 8" and 12" housings can be intermixed to form combination signals.

Door – One piece polycarbonate unit equipped with stainless steel hinge pins. Stainless steel captive eyebolts and wingnuts are used to hold the door against the housing.

Visor – The removable twist-on visor is secured to the door with stainless steel hardware. Cap, tunnel, and full circle visors are available.

Positive Positioning Positive positioning and locking is achieved through the use of serrated brackets, mast arm, or span wire fittings.

Terminal Block – All terminal blocks are composed of a sturdy polycarbonate weather resistant casing and stainless steel hardware. Terminal block is standardly installed in the yellow section of signal (second from top).

Hardware – Stainless steel material inside and outside.



Eagle Traffic Control Systems continues our 80+ year history of providing excellence in the ever evolving traffic industry. All of Eagle's products are developed with the highest standards of engineering and manufacturing. Eagle maintains a superior level of integrity in interactions with all of our business partners and customers. We also take tremendous pride in being model corporate citizens.

Item 1: SH, POLY, 1 SECTION, 12"

• Yellow

Item 2: SH, POLY, 3 SECTION, 12"

• Yellow

Item 3: SH, POLY, 3 SECTION, 12", BLACK

Item 4: SH, POLY, 4 SECTION, 12"

• Yellow

Item 5: SH, POLY, 4 SECTION, 12", BLACK

Item 6: SH, POLY, 1 SECTION, 12"

• Yellow

Item 7: SH, POLY, 5 SECTION, 12", BLACK

Eagle Traffic Control Systems is a division of:

mobotrex[™]
MOBILITY & TRAFFIC EXPERTS
MANUFACTURING

SG Polycarbonate d Vehicle Traffic Signal



Diagram

8" (200mm) &
12" (300mm)
traffic signals

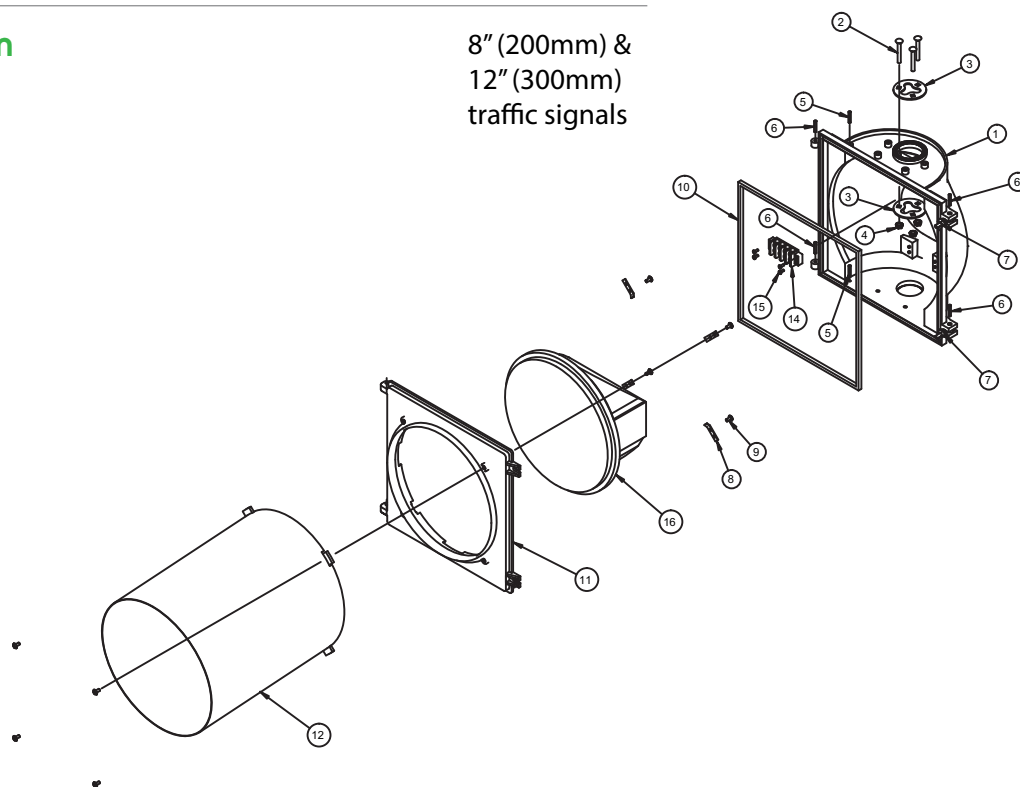

ightsW	8" Ø200 mm)	12" Ø300 mm)
Single section W	6.3 lbs (2.86 kg)	7.5 lbs (3.4 kg)
using OnlyW	4.2 lbs (1.91 kg)	5.3 lbs (2.41 kg)
Door OnlyW	1.1 lb (0.5 kg)	1.5 lbs (0.68 kg)
Visor OnlyW	0.8 lbs (0.36 kg)	1.4 lbs (0.64 kg)

12" (300 mm) Signal Dimensions

8" (200 mm) Signal Dimensions
8" (200mm) Signal Dimensions

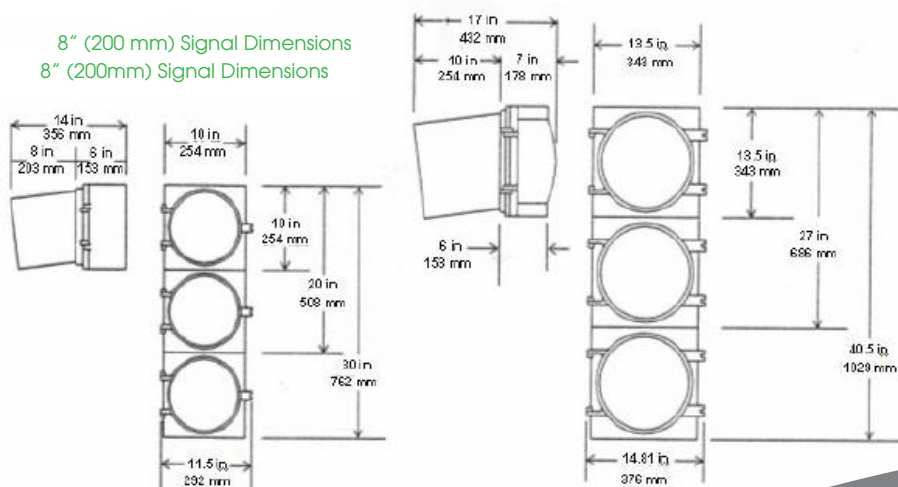

Eagle Traffic Control Systems is a division of:

mobotrex[™]
MOBILITY & TRAFFIC EXPERTS
MANUFACTURING

SG Polycarbonate d Vehicle Traffic Signal d



EAGLE[®]
Traffic Control Systems

Replacement PartsW

8" (200mm) &
12" (300mm)
Signals

Ref. No.W	Description	Part NumberW	
		8" (200mm)W	12" (300mm)W
1	Signal Housing G eend	A70022701	A70022901
	Signal Housing Yellow	A70022702	A70022902
	Signal Housing Bla k	A70022703	A70022903
2	Ca iage Bolt (1/4 - 20 x 1 3/4")	A701101SSd	A701101SS d
3d	Clamping Washer	M50417	M50417
4	Hex Nut (1/4 - 20)	M30221	M30221
5d	Type 2 G ove Pin, SS (8" - 3/16 x 1")	A8 44030	N/A
	Type 2 G ove Pin, SS (12" - 3/16 x 1 3/16")	N/A	A702181
6	Spi al Pin, SS (3/16" x 1")	A144006	A144006
7d	Wingnut Eyebolt Assemblyd	A844263	A844263
8	Lens clip, genericd	A84436155	A84436155
9	Lens clip sc ew, SS (10 - x 3/8")	0135021	0135021
10	Door gasketd	A701630	A701630
11	Signal door G eend	A70022801	A70023001
	Signal door Yellow	A70022802	A70023002
	Signal door Bla k	A70022803	A70023003
12	Visor - tunnel G eend	A70011901	A70012001
	Visor - tunnel Yellow	A70011902	A70012002
	Visor - tunnel Bla k	A70011903	A70012003
	Visor - cap G eend	A70046801	A70046901
	Visor - cap Yellow	A70046802	A70046902
	Visor - cap Bla k	A70046803	A70046903
	Visor - full ci cle G eend	A85228301	A85231901
	Visor - full ci cle Yellow	A85228302	A85231902
	Visor - full ci cle Bla k	A85228303	A85231903
13	Visor Sc ew (10 - 32 x 3/8")	0135021	0135021
14	Terminal blo k, 4 pos. spade type	A182944TX	A182944TX
	Terminal blo k, 6 pos. spade type	PCT100TX	PCT100TX
15	Machine sc ew, SS (6 - 32 x 3/4")	A16257312	A16257312

Eagle Td f ic Cont ol Systems is a division of:

mobotrex[™]
MOBILITY & TRAFFIC EXPERTS
MANUFACTURING

Signal Backplates



EAGLE[®]
Traffic Control Systems

Description

Traffic signal backplates are designed to properly shield a traffic signal from background obstructions. The backplate provides a dark silhouette that isolates the signal face from store lights, signs, sunlight and other environmental conditions that tend to reduce the brilliance of the light indications. A study found that back-plate plating can cut the number of vehicle accident claims at intersections by nearly 15%.



Features

- Cored holes and stainless steel thread forming screws are provided in the die cast aluminum and polycarbonate traffic signals for quick, easy installation of backplates.
- Aluminum backplates are fabricated from .063" 5052-H32 aluminum and are standardly primed and painted flat black on both sides. Aluminum backplating provides the strongest strength-weight ratio and is very resistant to weather and corrosion in harsh environments.
- Poly backplates are fabricated from .125" high density polyethylene (HDPE) and are standardly dull black on one side and semi-gloss black on the other side. Polyethylene backplating is very resistant to impacts and abrasions. It will also keep its strength and shape in extreme temperatures and severe weather conditions.
- Available with 1", 2" and 3" wide reflective tape installed in center or flush with outside edge. If reflective tape is required, the backplates will be fabricated from ABS material.



Item 12, Item 13, Item 15, Item 17: BP 1, 3, 4, & 5-SECTION, POLY 12"
Item 14, Item 16, Item 18: BP 3,4, & 5-SECTION, POLY, 12",
RETROREFLECTIVE
Item 25, Item 26, Item 28, Item 30: BACKPLATE 1, 3, 4, & 5-
SECTION, ALUMINUM 12"
Item 27, Item 29, Item 31: BP 1, 3, 4, & 5-SECTION, ALUMINUM, 12",
RETROREFLECTIVE
Item 32, Item 34, Item 36: BP 1, 3, 4, & 5-SECTION, LOUVERED, 12"
Item 33, Item 35, Item 37: BP 1, 3, 4, & 5-SECTION, LOUVERED, 12",
RETROREFLECTIVE

Eagle Traffic Control Systems is a division of:

mobotrex[™]
MOBILITY & TRAFFIC EXPERTS
MANUFACTURING

Signal Backplates



Backplate Number Construction CodeW

Prefix	Width of Border	Signal Configuration			Plumbizer Mounting Allowance	Profile	Hanger Style	Width of Reflective Tape	Tape Location	Special Options J	Paint Option -**
		Number of 8" (203mm) Housings	Number of 12" (300mm) Housings	Face Arrangement*							
BPA = Alum - SG	5 = 5"	0	0	A - Z	N = None E = Eagle R = Ryall (Frey)	F = Flat L = Louver	00 = None 01 = Span Wire 02 = Astro Bracket 03 = Other	0 = None 1 = 1" 2 = 2" 3 = 3"	N = None E = Edge C = Center	0 = None 1 = Multi 2 = Tape 3 = Louver Size or direction 4 = Hardware 5 = Other 6 = Louver centered	-00 = Flat Black -12 = Yellow <i>(Contact Brown for other paint b options)b</i>
BPB = Poly - SG		1	1								
BPAP = Alum-SG W/Reflect Tape		2	2								
BPBR = Poly -SG W/Reflect Tape		3	3								
BPC = Alum - SA	8 = 8"	4	4								
BPD = Poly - SA		5	5								
BPCR = Alum-SA W/Reflect Tape		6	6								
BPDR = Poly -SA W/Reflect Tape											

* Use the lowest signal alpha designation for the wanted signal arrangement. Reference VFA (Vehicle Face Arrangement) Chart.

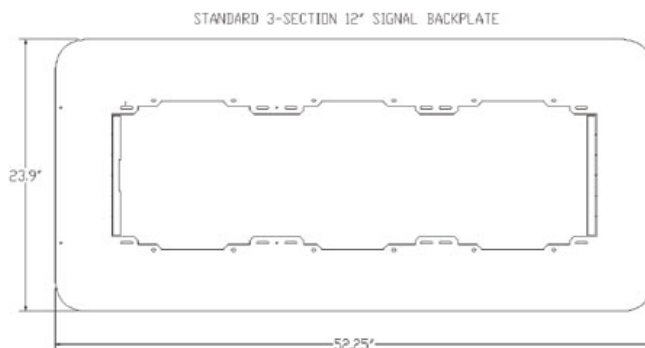
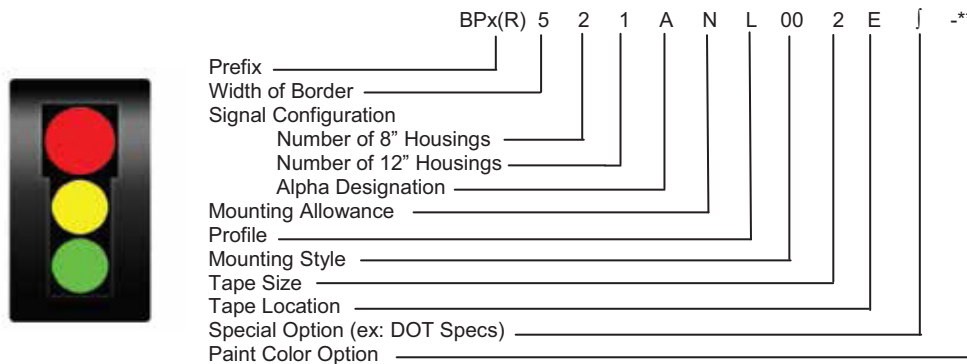

Eagle Traffic Control Systems is a division of:

mobotrexTM
MOBILITY & TRAFFIC EXPERTS
MANUFACTURING

Vacuum Formed Signal Backplates



EAGLE[®]
Traffic Control Systems

Description

Traffic signal backplates are designed to enhance the visibility of the traffic signal. The backplate provides a dark silhouette that isolates the signal face from street lights, sunlight, and other environmental conditions that can reduce the brilliance of the signal indications.

Features

- Eagle Vacuum Formed Backplates are fabricated from .125" thick ABS UV stabilized plastic sheet. This material is resistant to impacts and abrasions and will keep its strength and shape in extreme temperatures, continuous direct sunlight, and severe weather conditions. The vacuum forming process adds a 3/4" flange around the entire backplate to enhance the strength and rigidity of the backplate.
- This style of backplate is available for both SG and SA series signal heads, in 1, 3, 4, and 5-section inline and 5-section cluster heads. Reflective tape versions are available to further increase the visibility of the signal.
- All backplates include hardware to attach the backplate to the Eagle signal head.



Item 19, Item 21, Item 23: BP, 3, 4, & 5-SECTION, VACUUM FORMED ABS, 12"
Item 20, Item 22, Item 24: BP, 3, 4, & 5-SECTION, VACUUM FORMED ABS, 12", RETROREFLECTIVE



Eagle Traffic Control Systems continues our 80+ year history of providing excellence in the ever evolving traffic industry. All of Eagle's products are developed with the highest standards of engineering and manufacturing. Eagle maintains a superior level of integrity in interactions with all of our business partners and customers. We also take tremendous pride in being model corporate citizens.

Eagle Traffic Control Systems is a division of:

mobotrex[™]
MOBILITY & TRAFFIC EXPERTS
MANUFACTURING

Vacuum Formed Signal Backplates



EAGLE[®]
Traffic Control Systems

Options for Ordering

- SA or SG series
- Number of sections – 1, 3, 4, 5 in-line or 5-section cluster arrangement
- No Plumbizer or with Eagle or Frey Plumbizer
- No tape or with Reflective tape – 1", 2", or 3" wide
- Color – Standard Flat Black
- Contact MoboTrex for other Options

Ordering Information

Prefix	Width of Border	Signal Configuration		Plumbizer Mounting Allowance	Profile	Hanger Style	Width of Reflective Tape	Tape Location	Special Options
		Number of 12" Housings	Face Arrangement						
BVB = Poly SG	5 = 5"	1 3 4 5	A - Z	N = None E = Eagle R = Frey	F = Flat	00 = None 01 = Span Wire 02 = Astro Bracket 03 = Other	0 = None 1 = 1" 2 = 2" 3 = 3"	N = None E = Edge C = Center	0 = None 1 = Multi 2 = Tape 3 = Louver Size or Direction 4 = Hardware 5 = Other 6 = Louver Centered
BVBR = Poly SG with Reflective Tape									
BVD = Poly SA									
BVDR = Poly SA with Reflective Tape									

Eagle Traffic Control Systems is a division of:

mobotrex[™]
MOBILITY & TRAFFIC EXPERTS
>MANUFACTURING

- Item 38: POLY SIGNAL MOUNTING BRACKET, YELLOW**
 • Item Number 2 only / PDM0544302
Item 39: Item 22, Item 24: POLY SIGNAL MOUNTING BRACKET, BLACK
 • Item Number 2 only / PDM0544303

Side of Pole Assembly



EAGLE
Traffic Control Systems

Description

Eagle's Side-of-Pole assemblies are designed to mount traffic and pedestrian signals on the side of traffic signal poles with an upper and lower arm.

Item Number

UKS1452

Warranty

Eagle warrants to buyer that goods and services sold for use (except when used for personal purposes) here under will be free from defects in material and workmanship which appear within one (1) year of the date of shipment to the original buyer, provided that buyer notifies seller in writing of the the defects covered by this warranty within thirty (30) days of their first appearance. Seller's maximum obligation is to repair or replace goods which are proved to be defective. All warranty work is performed at factory.

UKS1452AB		
ITEM NUMBER	PART NUMBER	DESCRIPTION
1	M60615	NEOPRENE WASHER
2	PDM0544303	POLY BANDING BRACKET
3	PDM0545903	POLY ORNAMENT CAP
4	PDM0546003	POLY LOCK NIPPLE

UKS1452AG		
ITEM NUMBER	PART NUMBER	DESCRIPTION
1	M60615	NEOPRENE WASHER
2	PDM0544301	POLY BANDING BRACKET
3	PDM0545901	POLY ORNAMENT CAP
4	PDM0546003	POLY LOCK NIPPLE

UKS1452AY		
ITEM NUMBER	PART NUMBER	DESCRIPTION
1	M60615	NEOPRENE WASHER
2	PDM0544302	POLY BANDING BRACKET
3	PDM0545902	POLY ORNAMENT CAP
4	PDM0546003	POLY LOCK NIPPLE

UKS1452ABCH		
ITEM NUMBER	PART NUMBER	DESCRIPTION
1	M60615	NEOPRENE WASHER
2	PDM0544303	POLY BANDING BRACKET
3	PDM0545903	POLY ORNAMENT CAP
4	PDM0546003	POLY LOCK NIPPLE
5	PDM445	POLY SHIM

UKS1452AG		
ITEM NUMBER	PART NUMBER	DESCRIPTION
1	M60615	NEOPRENE WASHER
2	PDM0544302	POLY BANDING BRACKET
3	PDM0545902	POLY ORNAMENT CAP
4	PDM0546003	POLY LOCK NIPPLE
5	PDM445	POLY SHIM

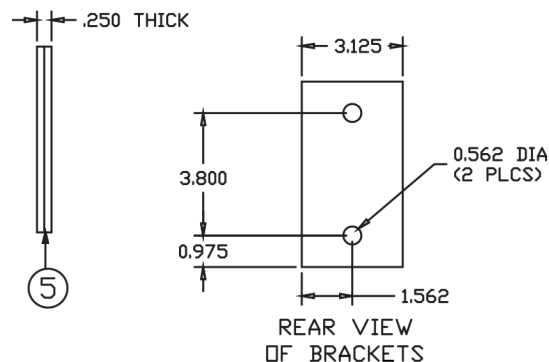
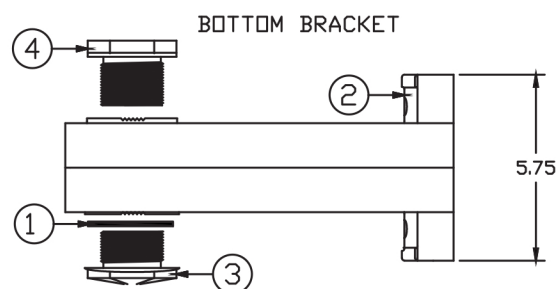
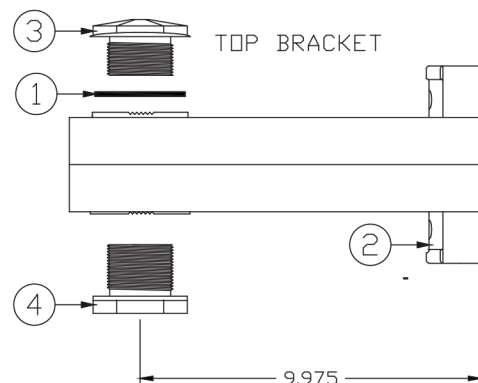

Eagle Traffic Control Systems continues our 80+ year history of providing excellence in the ever evolving traffic industry. All of Eagle's products are developed with the highest standards of engineering and manufacturing. Eagle maintains a superior level of integrity in interactions with all of our business partners and customers. We also take tremendous pride in being model corporate citizens.