



# Public Involvement WIS 44

**Bridge Overlay B-24-0019**

**Green Lake County**

**Project I.D. 6630-01-03/73**

**August 7, 2023 to August 21, 2023**

*More information is available for review on the project website: <https://wisconsindot.gov/Pages/projects/by-region/nc/default.aspx>*

*Deaf, hard-of-hearing, deaf-blind, and speech-disabled persons should contact the Wisconsin Relay Service by dialing 711.*

# Project Team

- WisDOT North Central Region
  - Felix Ogles, PE, Project Leader
- MSA Professional Services, Inc.
  - Quirin Klink, PE, Project Supervisor
  - Bobbi Maxwell, PE, Project Leader
  - Nathan Kindt, PE, Bridge Engineer



# Project Location

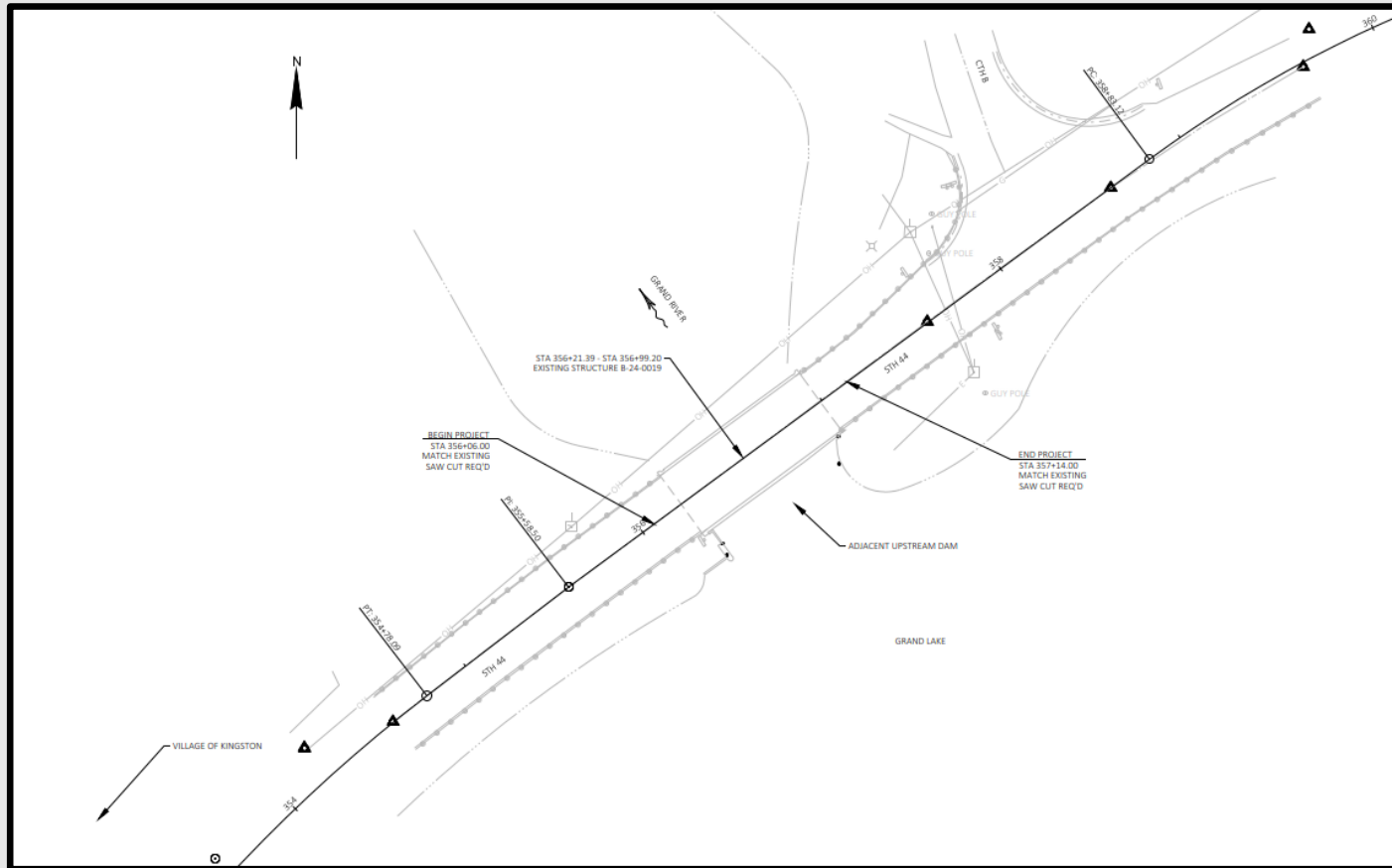

# B-24-0019 Project Schedule

- Local Officials Meeting – July 2023
- Public Involvement – August 2023
- Environmental Document – Fall 2023
- Final Plans – February 2024
- Letting – May 2024
- **Construction – 2024**



# B-24-0019 Project History

- Structure B-24-0019:
  - Original Bridge Construction: 1992
    - Bridge Type: Two-span haunched slab
    - Structure Length: 78 feet
    - Bridge foundations were built behind existing dam spillway walls (built 1913)
  - Previous Bridge Maintenance
    - Epoxy Deck Overlay: 2009
    - Deck Patching: 2015
- Project Need
  - Address bridge deficiencies



B-24-0019 (looking upstream)



# B-24-0019 Proposed Improvements

- Proposed Improvements
  - Concrete Overlay of B-24-0019 deck surface
  - Repair isolated deteriorated areas of the dam spillway walls under the bridge.



*Bridge Deck*



*Deteriorated Dam Spillway Wall*



# B-24-0019 Proposed Traffic Impacts

- The project is scheduled for construction in 2024.
  - May begin in mid to late summer 2024.
- Traffic concepts:
  - Single lane closures and shoulder closures utilizing temporary traffic signals
  - Access across the bridge will be maintained at all times
  - Access to and from the adjacent County B intersection will be maintained at all times





# Public Input

- Provide input by August 21, 2023
  - Complete and mail comment form found in handout
  - Via online survey on project website
    - <https://wisconsin.gov/Pages/projects/by-region/nc/default.aspx>
  - Via email or phone

Felix Ogles, P.E.  
Wisconsin Department of Transportation  
1681 2<sup>nd</sup> Avenue South  
Wisconsin Rapids, WI 54495-4768  
Phone: (715) 421-8329  
Email: [felix.ogles@dot.wi.gov](mailto:felix.ogles@dot.wi.gov)

Deaf, hard-of-hearing, deaf-blind, and speech-disabled persons should contact the Wisconsin Relay Service by dialing 711.

