

SIGNING AND MARKING

Problems with VUEWorks

Occasionally the system will begin to act strange or slow. When this happens:

1. Clear browser cache.
2. Restart the machine.
3. If you would like to select assets and your cursor will only show the Pan Map tool (4-headed arrow), try repeatedly clicking between the Pan Map tool (hand icon) and Select Asset tool (cursor/arrow icon) until the Pan Map tool becomes unstuck.
4. If everything above does not work, contact: DOTDLDTSDBTOTOAMSSupport@dot.wi.gov

Creating new Records

In VUEWorks currently only one person can be adding new records at one time per module. If you go to add a record and the editing drop downs don't appear. Try again later. Someone else is adding a record.

Multi Edit Function

If one of the fields is null and the others have fields have values, multi-edits will not work. When multi-editing:

1. Clear the field you want to edit and click save. (This will make all the values blank)
2. Enter the value you want all the assets to have and click save.

TIPS and Tricks

- On the search page, typing slower seems to work better. Be sure to wait for the field to populate before you click search.
- When updating records, if you can type faster it seems to work better. If there is too long of a pause between characters, a new search will start over in the list.
- When entering photolog marker(s): if it is a 2-digit number be sure to put the 0 in front of it or it will not sort it properly. Example type 032.54 instead of 32.54.
- Crossroad names can only be 50 characters.

Filtering to check work

- In VUEWorks, if you enter the "Year Manufactured" as 14 instead of 2014 it will now show up black.
- Be sure to enter in all fields that are needed. The only field that will auto calculate is SF of signs and painted footage for long line markings.
- To check some of this work, some filters have been created. Filters can be created and save by each individual person

General

- Send all Project IDs to Jeannie Silver by: **Jan 1, April 1, July 1, October 1**

- If you sort the Location or Label in the Data Viewer (lower left corner) and then click on a record and click the next button, the records will no longer be in that order (you cannot click the next button and go down the road in order of photolog marker)
- To filter for more than three attributes, use the GIS Assets instead of the Binocular tool or do multiple searches
- To filter for starts/ends use the GIS Assets drop down.
- When using the GIS Asset drop down for filtering, the program is very slow. Please be patient.
- Lat/Long Values will auto populate. These do not need to be filled in.
- Login Issues
 - Try different browser
 - Clear cache
- To help with log in issues. Try to clear searches
- Exporting to Excel
 - Preview the Report
 - Save the Report as Excel
 - Under “Setting” check “Export Data Only” and “Export Object Formatting”.
- Ways to save signs/markings that you are working on is to create a project
 - Filter to the assets you want
 - Click the Signs/Marking→Project button→Add Projects
 - On the additional pop up fill in the boxes and select Add Job

- On the next pop up screen fill in the boxes. Select from current available selection.
 - Note: to do special and long line, you must complete this twice.

- Select ok. And Save
- To find this again. Select Signs/Marking → Project button → Find/Manage/Report
- Select Table View or Filter to your Project
- Select your Project and Add to Selection.

[Form View](#) | [Table View](#) | [Filter](#) | [Reports](#) | [Assets](#)

***Project Title:**

***Project Group:**

Location:

Estimated Cost: \$33,404.01 **Actual Cost:** \$0.00 **Cost Overrun:** (\$33,404.01)

[Estimated Costs](#) | [Actual Costs](#) | [Details](#) | [Documents](#)

[Summary](#) | [Job Details](#) | [Overhead](#)

[Show Filter](#)

~~×~~ Delete All + Add Job + Add To Selection ~~×~~ Clear Selection Work Order

	Actions	Work Order ID	Asset Class	Asset Type
1			Pavement Marking	Longline Markings
2			Pavement Marking	Longline Markings

- This will load assets back into the Data Viewer

SIGNING SPECIFIC

Sign Classification

- **Regulatory**- all signs starting with R
- **Warning**- all signs starting with W
- **School**- all signs starting with S
- **Guide**- all signs starting with J, D, and I
- **Recreational & Cultural**- Do not use
- **Object Marker**- Do not use

Retiring/Reusing

Retire and create new records if:

- Sign code changes

Reuse if:

- Combining J-panels: (reuse 1 piece, retire the others)
- Remove and replace (projects & Counties)
- Larger/smaller signs

If you accidentally retire a record, contact Mary Elizabeth.

Sizes of D signs

Counties should be noting the size of these signs. Please send these to the data editors so they can put the correct sizes in VUEWorks. We do you these numbers

MARKING SPECIFIC

Retiring vs reusing records

Retire and create new records if

New alignments

New configurations (added TWLTL/ Turn lanes)

Change in condition (yield line to stop line)

Reuse if:

No alignment changes

Retrace Field

History for markings is not being carried over. We plan to use the Maintained? Box for retracing. Example:

Initial Waterborne

Initial Tape

Initial Epoxy

Retrace Epoxy over Tape

Retrace epoxy over epoxy

Retrace waterborne over epoxy

Retrace waterborne over waterborne

Standardizing Record Entry:

- Lane lines – 1 record if it calculates it correctly, otherwise we will need this to be separate records.
- Aerial Enforcement Bars- 1 record for all bars with the total number of bars as the quantity
- Painted chevrons & Painted Medians- 1 record for total footage per location
- Service/Frontage Roads – Frontage roads should be the route name and the mainline would be the Site ID
- Crossroads/Island Noses/Curbs –When the marking is to the right use that travel direction. The stuff on the crossroad should have a site id of that crossroad name and a position of crossroad.
- Arrows/Words- One record for mainline assets in each direction and one record for crossroad assets (if they are state maintained).
- Crosswalks – Route should be in the Cardinal direction
- There are some color-coded pictures to help clarify.

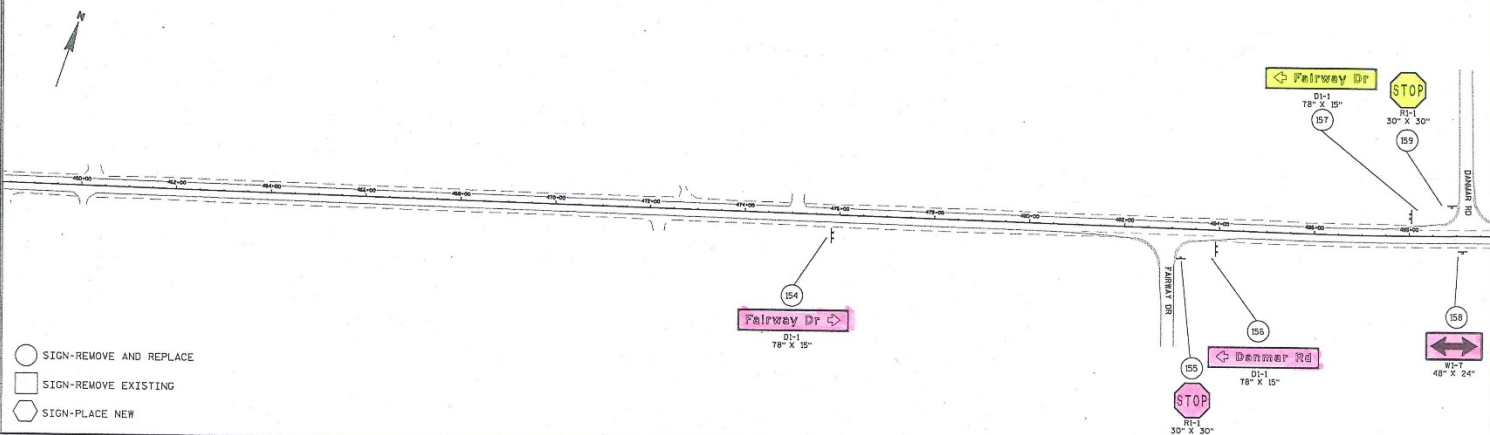
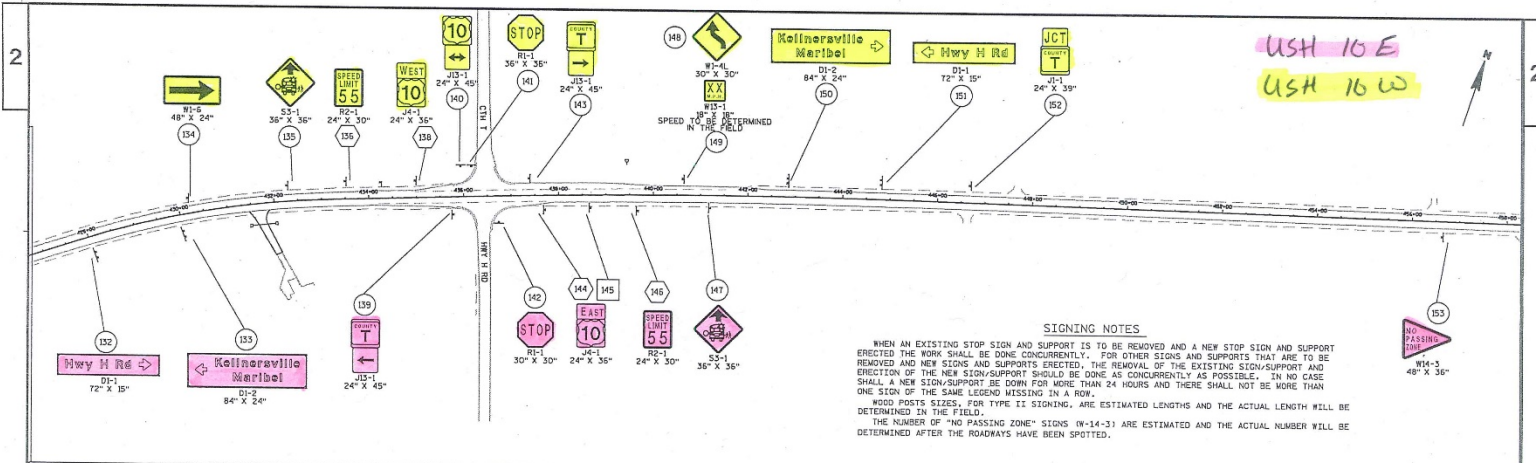

- SIGN-REMOVE AND REPLACE
- SIGN-REMOVE EXISTING
- SIGN-PLACE NEW

PROJECT NO: 1500-66-71-_____ HWY: USH 10 COUNTY: MANITOWOC PERMANENT SIGNING SHEET E

FILE NAME : N:\spn\Traffic\SIGNING\Projects\1500-33-71 1500-66-71 USH 10 Manitowoc Co\15006671.signplan.dgn PLOT DATE : 24-MAY-2017 11:36 PLOT BY : dotets PLOT NAME : PLOT SCALE : 200:1 WISDOT/CADDS SHEET 42

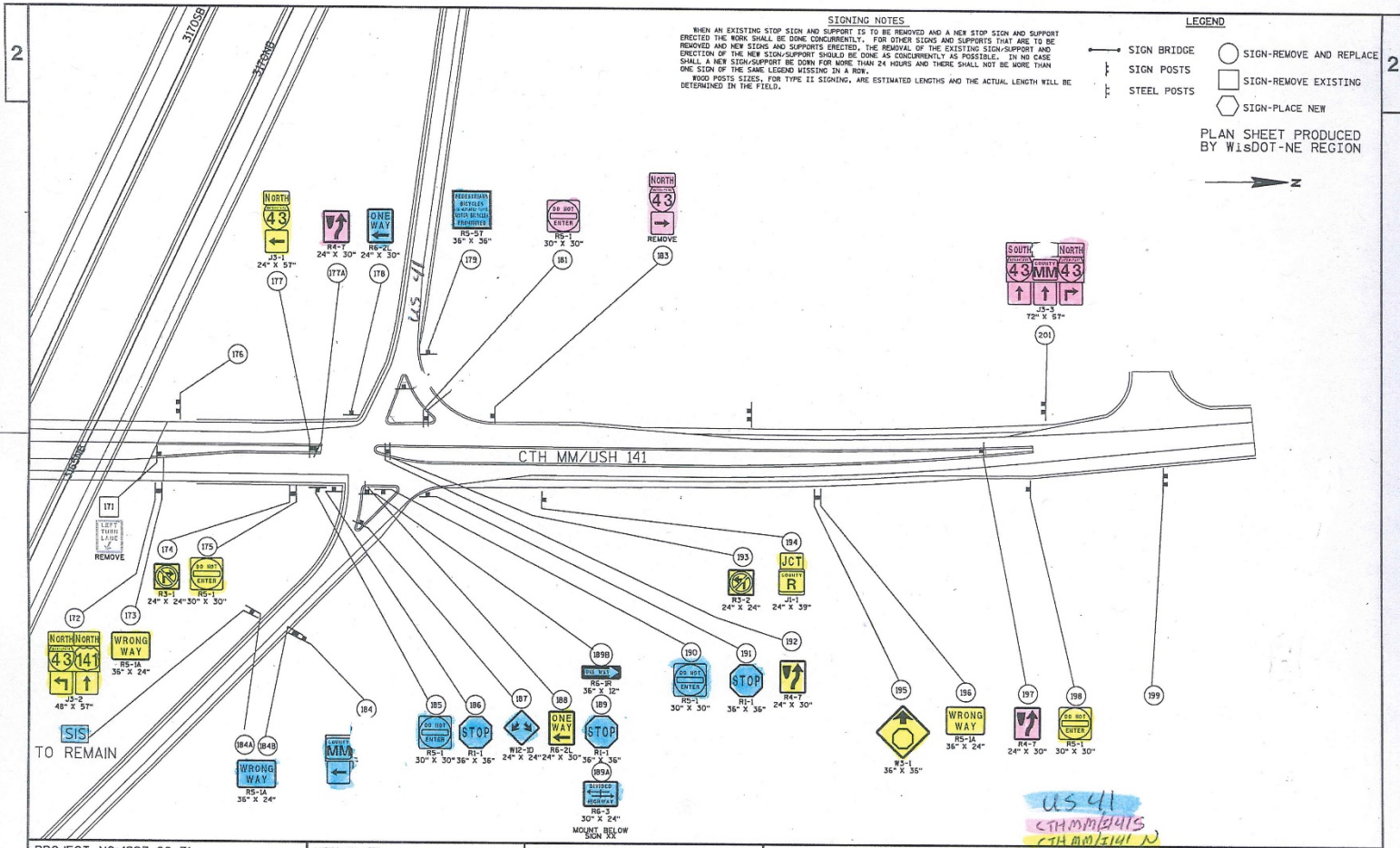

SIGNING NOTES

WHEN AN EXISTING STOP SIGN AND SUPPORT IS TO BE REMOVED AND A NEW STOP SIGN AND SUPPORT ERRECTED THE WORK SHALL BE DONE CONCURRENTLY. FOR OTHER SIGNS AND SUPPORTS THAT ARE TO BE REMOVED AND NEW SIGNS AND SUPPORTS ERRECTED, THE REMOVAL OF THE EXISTING SIGN/SUPPORT AND ERRECTION OF THE NEW SIGN/SUPPORT SHOULD BE DONE AS CONCURRENTLY AS POSSIBLE. IN NO CASE SHALL A NEW SIGN/SUPPORT BE DOWN FOR MORE THAN 24 HOURS AND THERE SHALL NOT BE MORE THAN ONE SIGN OF THE SAME LEGEND MISSING IN A ROW.
 ROAD POSTS SIZES, FOR TYPE II SIGNING, ARE ESTIMATED LENGTHS AND THE ACTUAL LENGTH WILL BE DETERMINED IN THE FIELD.

LEGEND

- SIGN BRIDGE
 - SIGN POSTS
 - STEEL POSTS
 - SIGN-REMOVE AND REPLACE
 - SIGN-REMOVE EXISTING
 - ◇ SIGN-PLACE NEW
- PLAN SHEET PRODUCED BY WISDOT-NE REGION
- N

PROJECT NO: 1227-08-71

HWY: IH-43

COUNTY: BROWN

PERMANENT SIGNING

SHEET

E

FILE NAME : N:\spat\traffic\SIGNING\Projects\1227-08-71 I-43 Brown Co\43brown.dwg

PLOT DATE : 30-MAR-2016 17:19

PLOT BY : doteta

PLOT NAME :

PLOT SCALE : 100:1

WISDOT/CADD SHEET 42

Handwritten: US 41
 CTH MM/USH 141
 CTH MM/USH 141 N

SIGNING NOTES

WHEN AN EXISTING STOP SIGN AND SUPPORT IS TO BE REMOVED AND A NEW STOP SIGN AND SUPPORT ERRECTED THE WORK SHALL BE DONE CONCURRENTLY. FOR OTHER SIGNS AND SUPPORTS THAT ARE TO BE REMOVED AND NEW SIGNS AND SUPPORTS ERRECTED, THE REMOVAL OF THE EXISTING SIGN/SUPPORT AND ERRECTION OF THE NEW SIGN/SUPPORT SHOULD BE DONE AS CONCURRENTLY AS POSSIBLE. IN NO CASE SHALL A NEW SIGN/SUPPORT BE DOWN FOR MORE THAN 24 HOURS AND THERE SHALL NOT BE MORE THAN ONE SIGN OF THE SAME LEGEND MISSING ON A ROAD.

WOOD POSTS SIZES, FOR TYPE II SIGNING, ARE ESTIMATED LENGTHS AND THE ACTUAL LENGTH WILL BE DETERMINED ON THE FIELD.

INSTALL 18" X 18" ORANGE PLATE ON TOP OF THE YIELD SIGNS FOR THE FIRST SIX MONTHS OF OPERATION OF THE ROADWAY TO EMPHASIZE THE YIELD MOVEMENT.

ALL YIELD SIGNS SHALL HAVE A MOUNTING HEIGHT OF 7' - 3" TO THE BOTTOM OF THE YIELD SIGN.

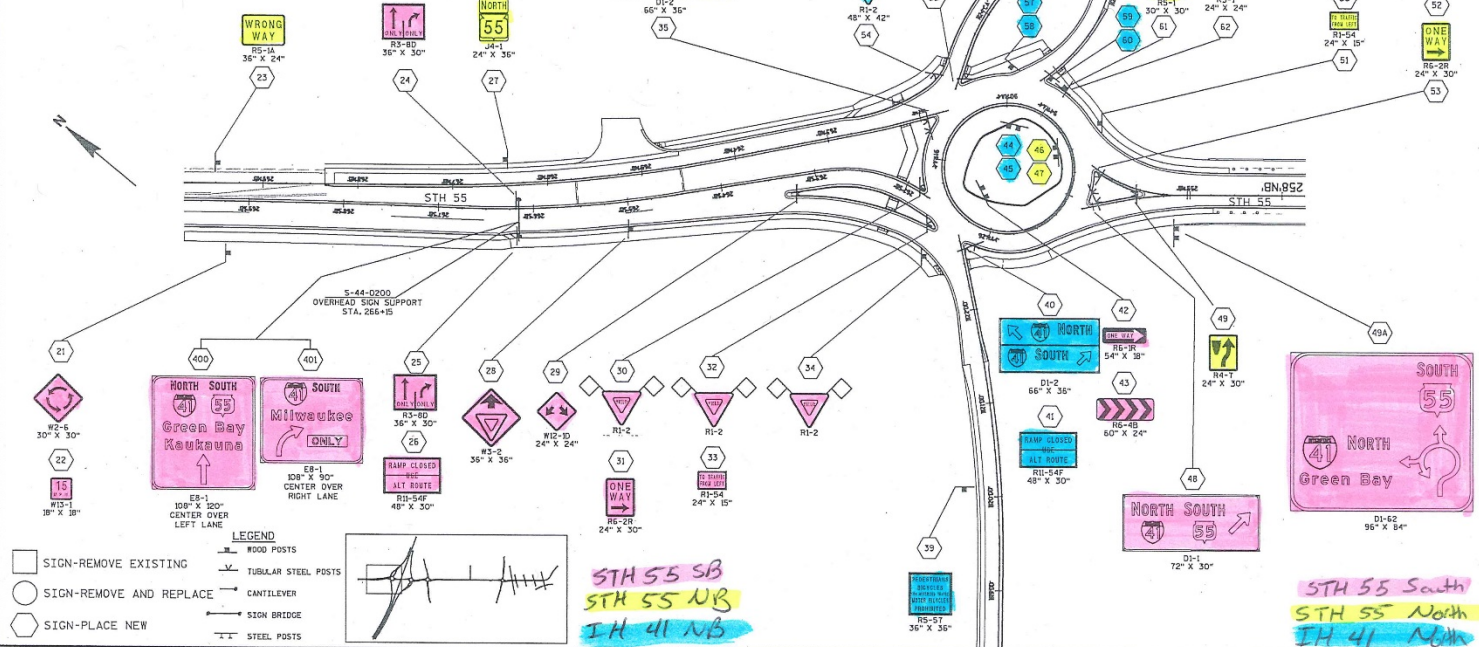

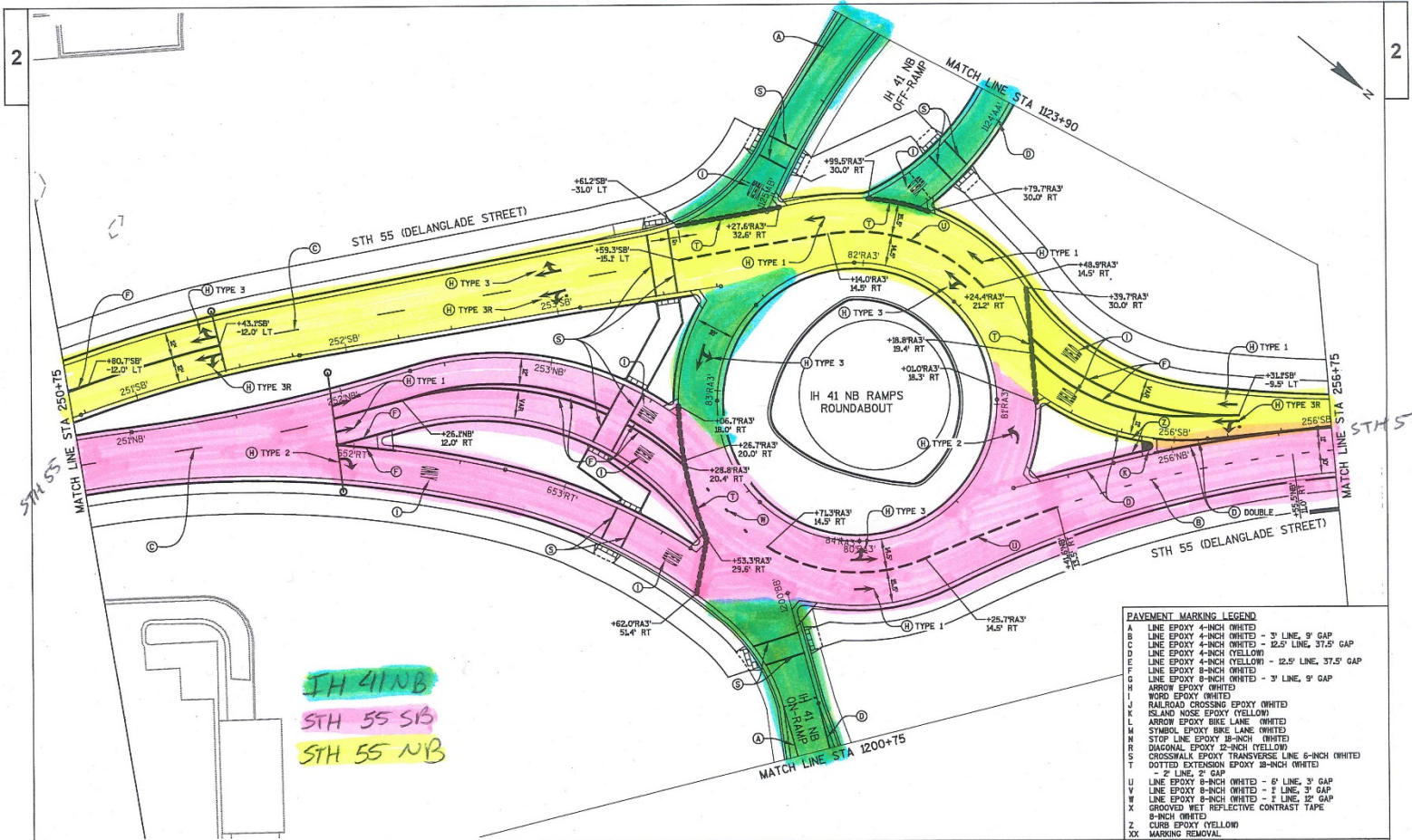

IH 41 NB
 STH 55 SB
 STH 55 NB

PAVEMENT MARKING LEGEND

A	LINE EPOXY 4-INCH (WHITE)
B	LINE EPOXY 4-INCH (WHITE) - 3' LINE, 9' GAP
C	LINE EPOXY 4-INCH (WHITE) - 12.5' LINE, 37.5' GAP
D	LINE EPOXY 4-INCH (YELLOW)
E	LINE EPOXY 6-INCH (YELLOW) - 12.5' LINE, 37.5' GAP
F	LINE EPOXY 8-INCH (WHITE)
G	LINE EPOXY 8-INCH (WHITE) - 3' LINE, 9' GAP
H	ARROW EPOXY (WHITE)
I	ROAD EPOXY (WHITE)
J	RAILROAD CROSSING EPOXY (WHITE)
K	ISLAND NOSE EPOXY (YELLOW)
L	ARROW EPOXY (BIKE LANE) (WHITE)
M	SYMBOL EPOXY (BIKE LANE) (WHITE)
N	STOP LINE EPOXY (8-INCH) (WHITE)
R	DIAGONAL EPOXY (12-INCH) (YELLOW)
S	CROSSWALK EPOXY TRANSVERSE LINE (8-INCH) (WHITE)
T	DOTTED EXTENSION EPOXY (8-INCH) (WHITE)
U	- 2' LINE, 2' GAP
V	LINE EPOXY 8-INCH (WHITE) - 6' LINE, 3' GAP
W	LINE EPOXY 8-INCH (WHITE) - 1' LINE, 3' GAP
X	GROOVED NET REFLECTIVE CONTRAST TAPE
Z	8-INCH (WHITE)
XX	MARKING REMOVAL

PAVEMENT MARKING LEGEND

- ① PAVEMENT MARKING EPOXY 4-INCH (DOUBLE YELLOW)
- ② PAVEMENT MARKING EPOXY 4-INCH (YELLOW)
- ③ PAVEMENT MARKING EPOXY 4-INCH (WHITE)
- ④ PAVEMENT MARKING EPOXY 4-INCH (WHITE) 3' LINE, 9' GAP
- ⑤ PAVEMENT MARKING EPOXY 4-INCH (YELLOW) 12.5' LINE, 37.5' GAP
- ⑥ PAVEMENT MARKING EPOXY 8-INCH (WHITE)
- ⑦ PAVEMENT MARKING EPOXY 8-INCH (WHITE) 3' LINE, 9' GAP
- ⑧ PAVEMENT MARKING DIAGONAL EPOXY 12-INCH (WHITE)
- ⑨ PAVEMENT MARKING ARROWS EPOXY TYPE 1
- ⑩ PAVEMENT MARKING ARROWS EPOXY TYPE 2
- ⑪ PAVEMENT MARKING ARROWS EPOXY TYPE 3
- ⑫ PAVEMENT MARKING CROSSWALK EPOXY 6-INCH
- ⑬ PAVEMENT MARKING STOP LINE EPOXY 18-INCH
- ⑭ PAVEMENT MARKING WORDS EPOXY
- ⑮ PAVEMENT MARKING SYMBOLS BIKE LANE EPOXY
- ⑯ PAVEMENT MARKING ARROWS BIKE LANE EPOXY
- ⑰ PAVEMENT MARKING WORDS BIKE LANE EPOXY

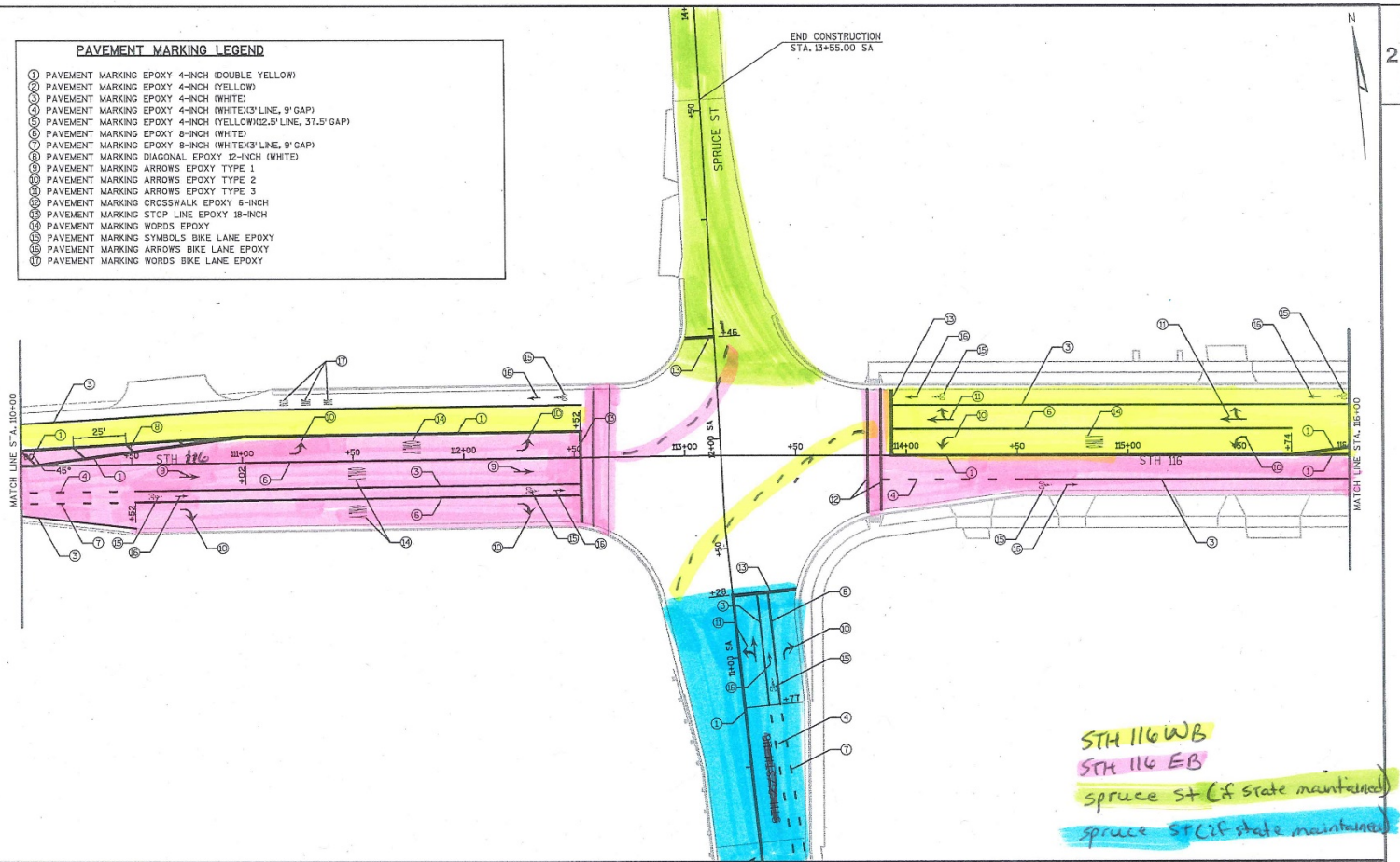

END CONSTRUCTION
STA. 11+55.00 SA

SPRUCE ST

MATCH LINE STA. 110+00

MATCH LINE STA. 115+00

STH 116 WB
STH 116 EB
spruce st (if state maintained)
spruce spc (if state maintained)

PROJECT NO: 6190-16-72

HWY: STH 116

COUNTY: WINNEBAGO

PAVEMENT MARKING

SHEET

E

FILE NAME : S:\MAD\1000-1089\1089\342\Microe\Plan\024602.dwg

PLOT DATE : 2/28/2017

PLOT BY : _username_

PLOT NAME :

PLOT SCALE : 1/8" = 1'-0" PLOT SCALE : 1/8" = 1'-0" WISDOT/CADD SHEET 42